

**AERODROME/HELIPORT  
CHART - ICAO**

05° 55' 55"N  
116° 03' 01"E

ELEV 4 M

TWR 118.3  
SMC 121.6  
ATIS 127.4

**KOTA KINABALU/KOTA KINABALU  
INTERNATIONAL AIRPORT**

RWY	DIRECTION	THR	BEARING STRENGTH
02	023°	05° 55' 05.35" N 116° 02' 35.35" E	PCR 693/F/B/W/U ASPHALT
20	203°	05° 56' 50.60" N 116° 03' 19.79" E	
HOT SPOTS			
HS 1 AIRCRAFT ENTERING RWY 02 MUST STOP AT HOLDING POSITION TWY J			
HS 2 AIRCRAFT EXITING TAXILANE MUST HOLD SHORT TAXIWAY M			
HS 3 AIRCRAFT EXITING TO APRON T2 SHALL TAKE EXTRA PRECAUTIONS DUE TO GA MOVEMENT AT THIS AREA			

TAXIWAYS A, F AND G 23M WIDE  
TAXIWAYS B 31M WIDE  
TAXIWAYS C AND E 26M WIDE  
TAXIWAYS D AND J 30M WIDE  
TAXIWAYS H, K AND N 27M WIDE  
TAXIWAYS L AND M 40M WIDE  
TAXIWAYS FC 11M WIDE  
APRON TAXIWAY (A1,M1,M2) 23M WIDE  
AIRCRAFT STAND TAXILANE (B1) 15M WIDE  
AIRCRAFT STAND TAXILANE (J1,L1) 23M WIDE

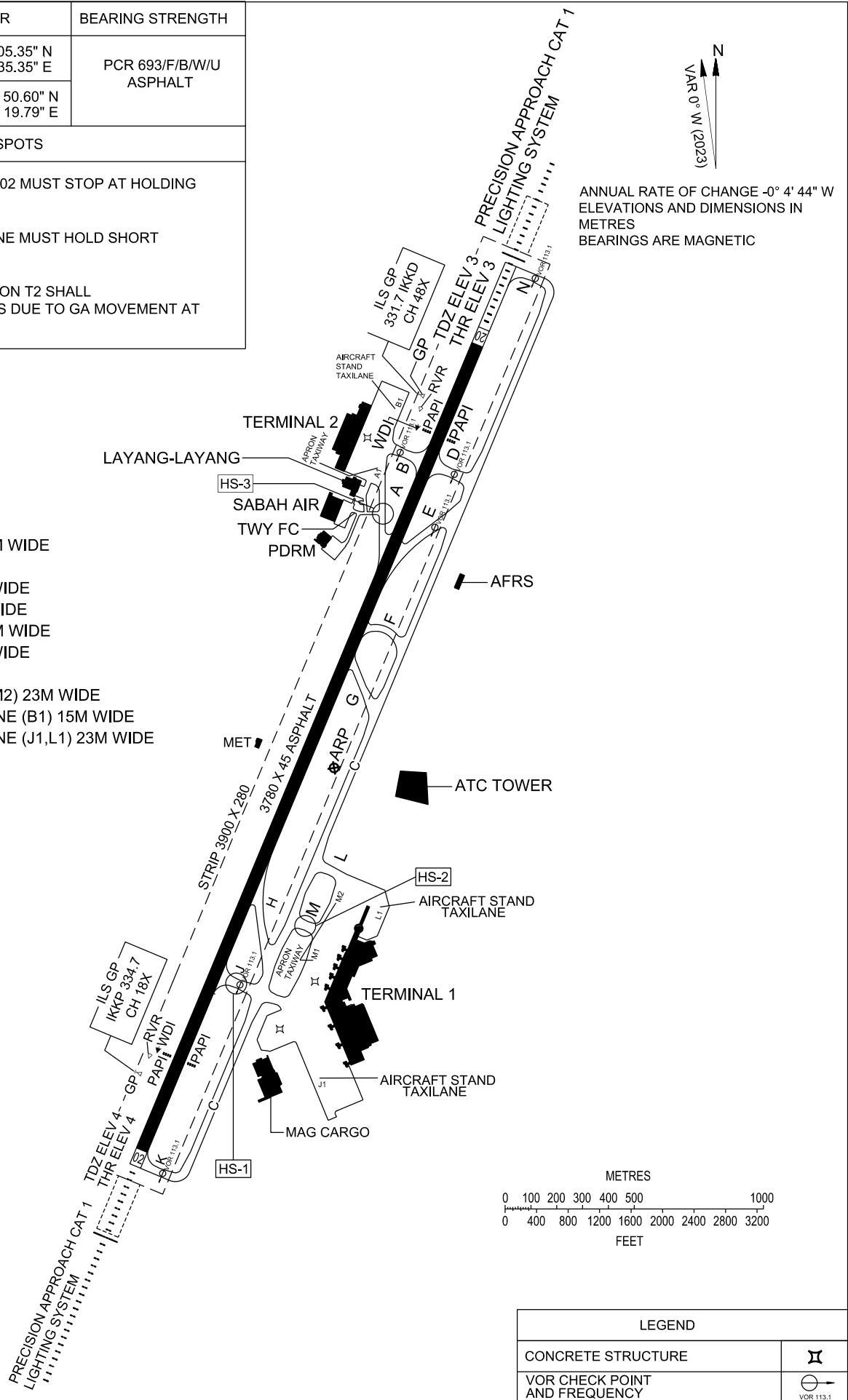

ANNUAL RATE OF CHANGE -0° 4' 44" W  
ELEVATIONS AND DIMENSIONS IN METRES  
BEARINGS ARE MAGNETIC

**CHANGES : PAVEMENT BEARING STRENGTH**