

**AERODROME/HELIPORT
CHART - ICAO**

02° 15' 47" N
102° 15' 09" E ELEV 12 M

TWR 118.0
SMC 121.6
ATIS 127.45

**MALACCA/
MALACCA AIRPORT**

RWY	DIRECTION	THR	BEARING STRENGTH
03	29°	02° 15' 25.96" N 102° 14' 52.70" E	PCR 444/F/D/X/U ASPHALT (FLEXIBLE)
21	209°	02° 16' 26.09" N 102° 15' 27.36" E	

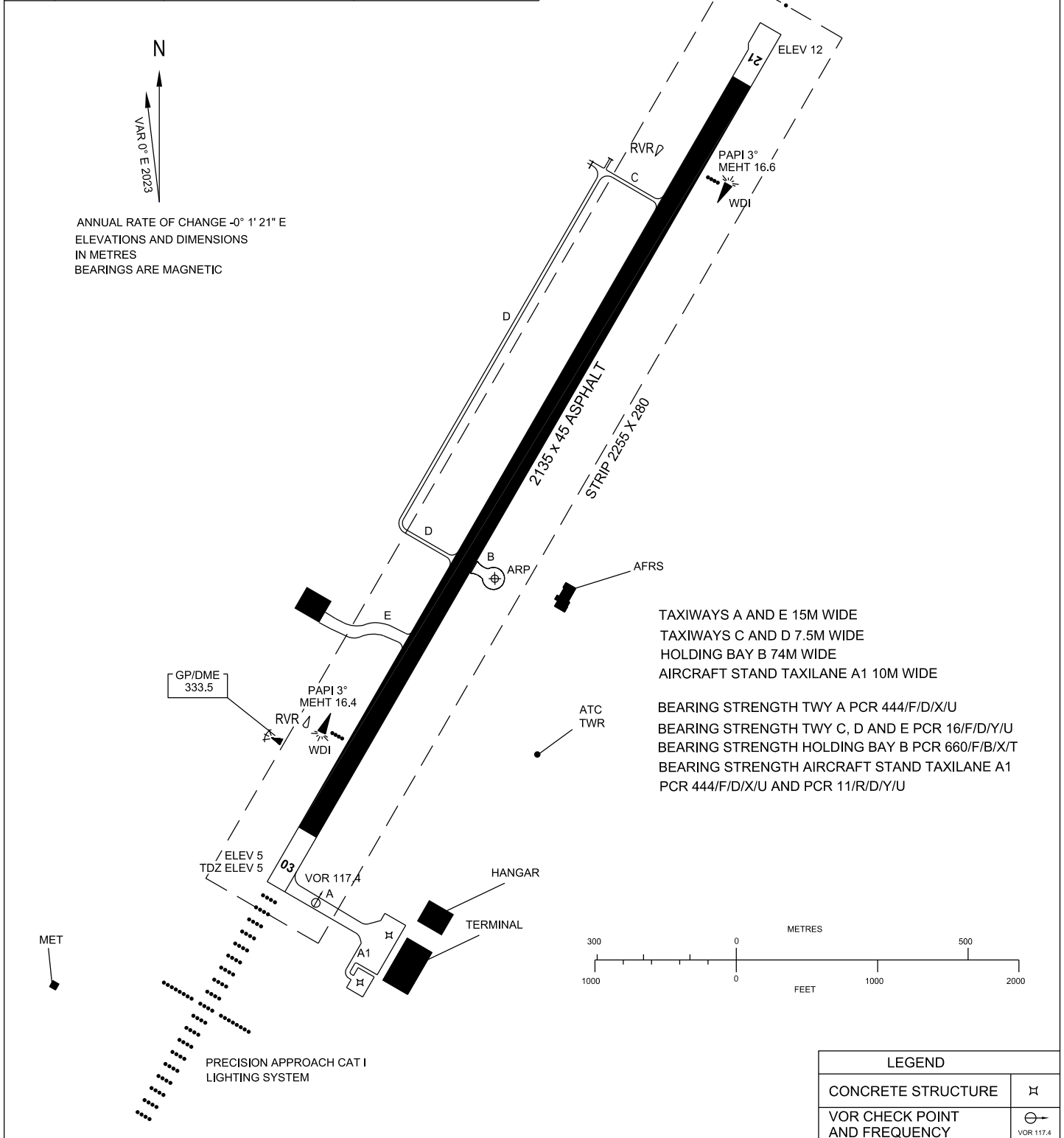

CHANGES : PAVEMENT BEARING STRENGTH
ADD INFO ON HOLDING BAY B