

**AIRCRAFT PARKING / DOCKING CHART - ICAO**

APRON ELEV  
10 M

RWY 32L/14R	KLIA (TERMINAL 2)	RWY 33/15	ACD
TWR 118.500	GND 121.725	TWR 119.800	126.0
GND 121.800	GND 122.550	GND 118.050	128.15
GND 122.525	GND 130.750		

**SEPANG / KL INTERNATIONAL AIRPORT**

**TERMINAL 2**

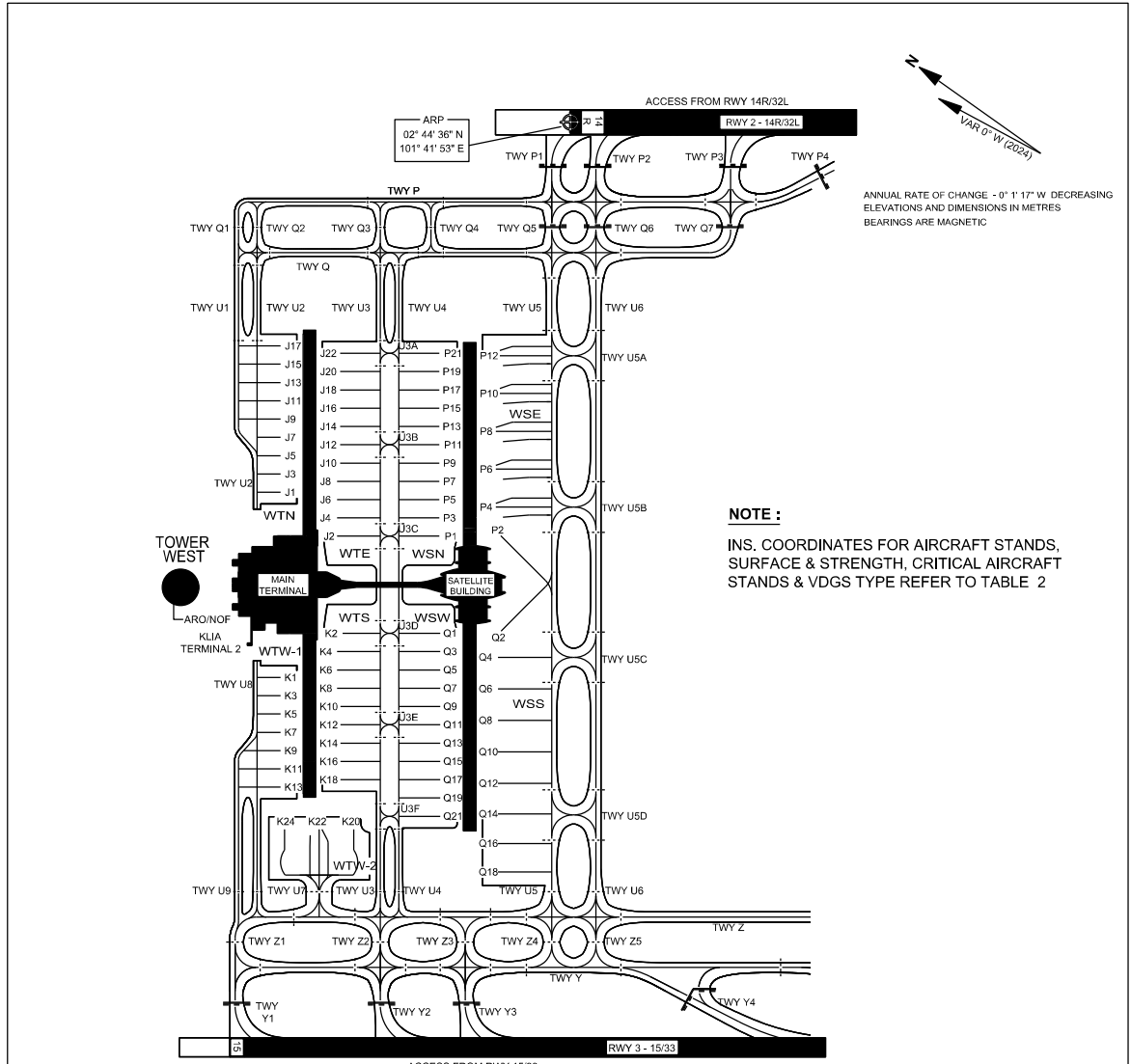

TWY U3A UNTIL U3F, P & Q (CODE C), Q1 UNTIL Q4 18 M WIDE  
 TWY U6, U5A UNTIL U5D, P & Q (CODE E & F), P1 UNTIL P4, Q5, Q6, Q7, Y & Z 25 M WIDE  
 TWY Y1 & Y9 31 M WIDE  
 TWY Z1 33 M WIDE  
 TWY Y6 & Y7 34 M WIDE  
 TWY Y2 UNTIL Y5 & Y8 35 M WIDE  
 TWY Z2 UNTIL Z8 40 M WIDE  
 TWY U7 61 M WIDE  
 APN TWY U3 & U4 18 M WIDE  
 APN TWY U5 25 M WIDE  
 ACFT STAND TAXILANE U1, U2, U8 & U9 18 M WIDE  
 BEARING STRENGTH P1, P2, Y1, Y2, Y8 & Y9 PCR 1179/R/C/W/U  
 BEARING STRENGTH TWY P & Q (CODE C) PCR 1232/F/D/X/U  
 BEARING STRENGTH U3A UNTIL U3F, Q1 UNTIL Q4, U3, U4, U1, U2, U8 & U9 PCR 651/F/D/X/U  
 BEARING STRENGTH TWY U6, P & Q (CODE E & F), Y, Z, U5A UNTIL U5D, P3, P4, Q5, Q6, Q7  
 Y3 UNTIL Y7, Z1 UNTIL Z8, U5 & U7 PCR 1232/F/D/X/U

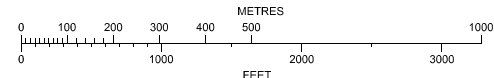

LEGEND	
AIRCRAFT STAND	P3
TAXIWAY LIGHTS	●
RUNWAY-HOLDING POSITION	—
INTERMEDIATE HOLDING POSITION	---

CHANGES : UPDATE INFORMATION ON TWY, APN TWY, ACFT STAND TAXILANE WIDTH AND BEARING STRENGTH