

**TAXI ROUTE CODE F -
ARRIVAL RUNWAY 33**

| | | | | | |
|------------|-------------|-------------|-------------|---------|---------|
| APRON ELEV | RWY 14L/32R | RWY 14R/32L | RWY 15/33 | GROUND | GROUND |
| EAST 19 M | TWR 118.800 | TWR 118.500 | TWR 119.800 | 122.150 | 121.725 |
| WEST 10 M | GND 121.650 | GND 121.800 | GND 118.050 | 122.850 | 122.550 |
| | | GND 122.525 | | 122.275 | 130.750 |
| | | | | 123.250 | |

**SEPANG/
KL INTERNATIONAL
AIRPORT**

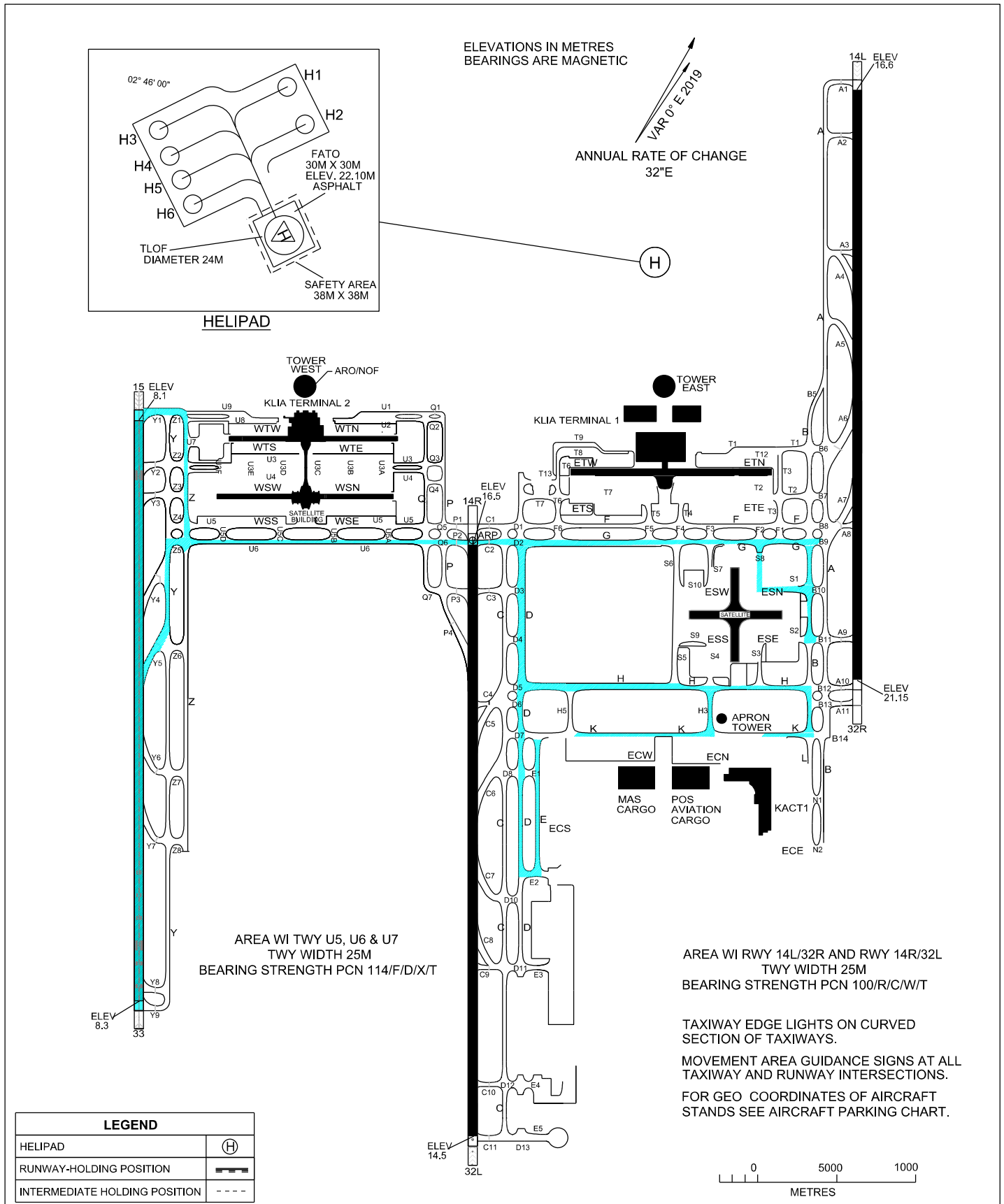

CHANGES : KLIA2 MAIN TERMINAL TO KLIA TERMINAL 2
MAIN TERMINAL TO KLIA TERMINAL 1.