

**AIRCRAFT PARKING/  
DOCKING CHART - ICAO**

APRON ELEV  
4 M

TWR 121.1  
SMC 121.6  
121.9  
ATIS 126.4

**PENANG/PENANG  
INTERNATIONAL AIRPORT**

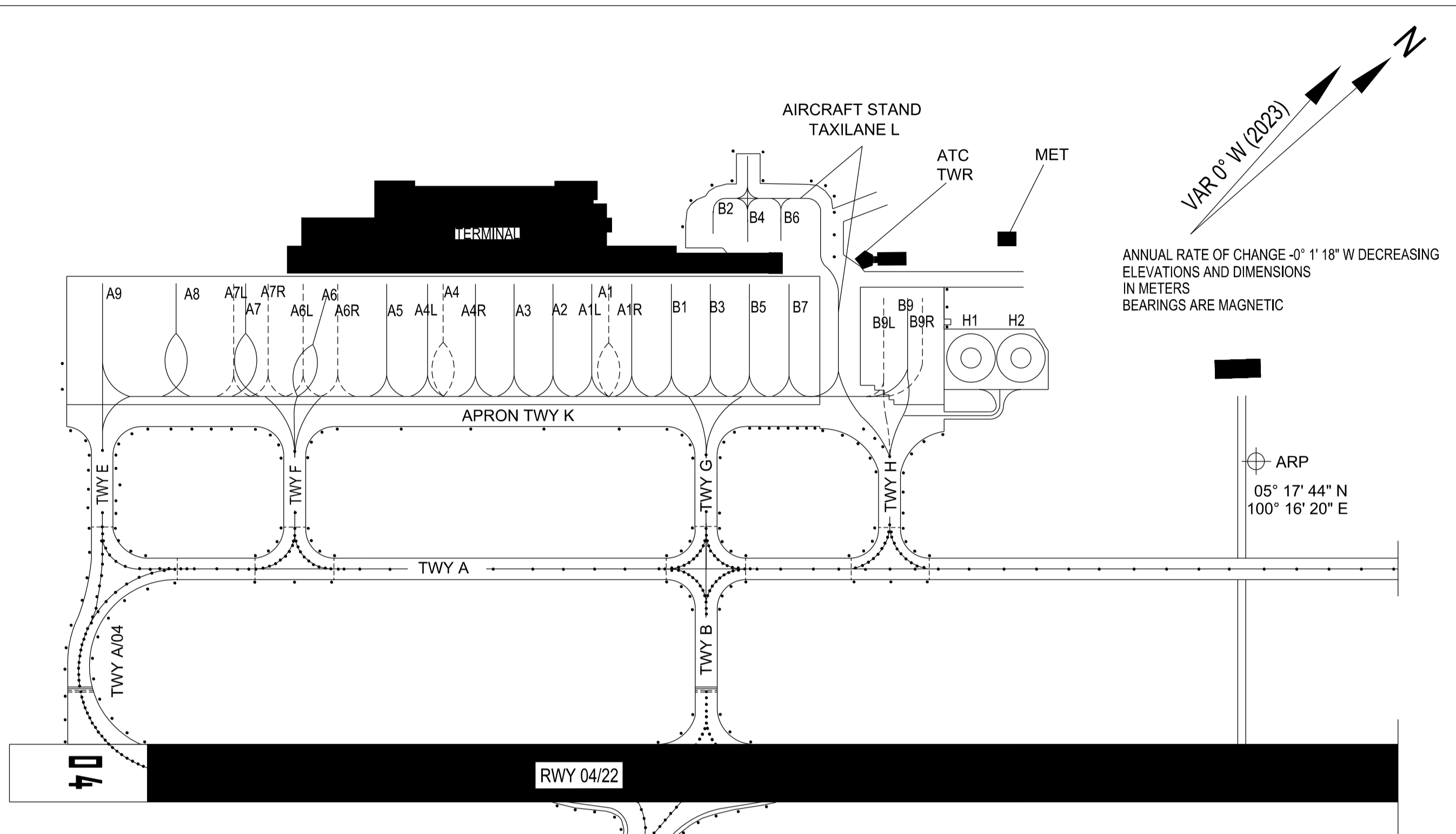

AIRCRAFT STAND TAXILANE J1

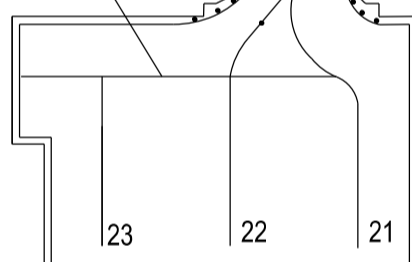

SECOND CARGO COMPLEX

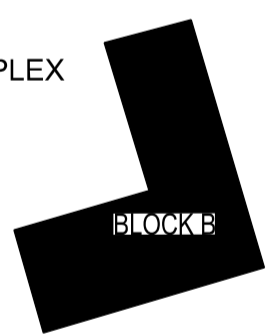

BLOCK B

- TAXIWAY A, C AND E 23M WIDE
- TAXIWAY A/04 AND A/22 30M WIDE
- TAXIWAY B AND D 34M WIDE
- TAXIWAY F AND H 31M WIDE
- TAXIWAY G 32M WIDE
- TAXIWAY J 25M WIDE
- APRON TAXIWAY K 24M WIDE
- AIRCRAFT STAND TAXILANE J1 48M WIDE
- AIRCRAFT STAND TAXILANE L 42M WIDE

RESTRICTED ROUTE FOR B747-800 OPERATIONS ARE  
TAXIWAYS A, H, A04, A22 AND PARKING IS BAY B9

- BEARING STRENGTH TWY A PCN 74/F/A/W/T
- BEARING STRENGTH TWY A/04 PCN 74/R/A/W/T AND PCN 74/F/A/W/T
- BEARING STRENGTH TWY A/22 PCN 74/F/A/W/T
- BEARING STRENGTH TWY B PCN 62/R/A/W/T AND PCN 62/F/A/W/T
- BEARING STRENGTH TWY C PCN 63/F/A/W/T
- BEARING STRENGTH TWY D PCN 88/F/A/W/T
- BEARING STRENGTH TWY E PCN 64/F/A/W/U
- BEARING STRENGTH TWY F PCN 64/F/A/W/U
- BEARING STRENGTH TWY G PCN 64/F/A/W/U
- BEARING STRENGTH TWY H PCN 67/F/A/W/T
- BEARING STRENGTH TWY J PCN 67/R/B/W/T
- BEARING STRENGTH APRON TWY K PCN 132/R/D/W/U
- BEARING STRENGTH AIRCRAFT STAND TAXILANE J1 PCN 67/R/B/W/T
- BEARING STRENGTH AIRCRAFT STAND TAXILANE L PCN 67/F/A/W/T

AIRCRAFT STANDS A1, A1R, A1L, A3, A4, A4R, A4L, A5, A6, A6R FMT APIS ++ EQUIPPED  
AIRCRAFT STANDS A2, B1, B3, B5, B7 SAFEGATE EQUIPPED

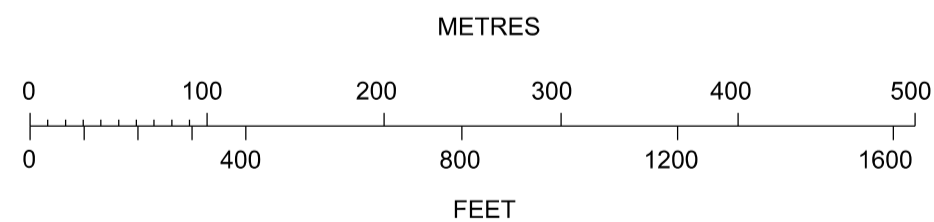

LEGEND	
AIRCRAFT STAND	23
TAXIWAY LIGHT	•
RUNWAY-HOLDING POSITION	=====
INTERMEDIATE HOLDING POSITION	----

**CHANGES:** UPDATE TAXIWAY WIDE  
UPDATE INFORMATION ON AIRCRAFT STAND TAXILANE 'L'