

**AERODROME/HELIPORT
CHART - ICAO**

04° 02' 58" N
114° 48' 34" E

ELEV 27 M

TWR	129.200 (P)
	121.700 (S)
EMERG	121.5

**MULU/
MULU AIRPORT**



ANNUAL RATE OF CHANGE 0.08° W
ELEVATIONS AND DIMENSIONS IN METRES
BEARINGS ARE MAGNETIC

RWY	DIRECTION	THR	BEARING STRENGTH
03	035° T	04° 02' 56.16" N 114° 48' 29.57" E	RWY, TWY AND APN PCN 19/F/C/X/T ASPHALT
21	215° T	04° 03' 34.98" N 114° 48' 56.31" E	

INS COORDINATES FOR AIRCRAFT STANDS	BEARING STRENGTH	AIRCRAFT TYPE
1 04° 02' 57.51" N 114° 48' 37.44" E	PCN 19/F/C/X/T	ATR 72
2 04° 02' 59.00" N 114° 48' 38.46" E	PCN 19/F/C/X/T	ATR 72

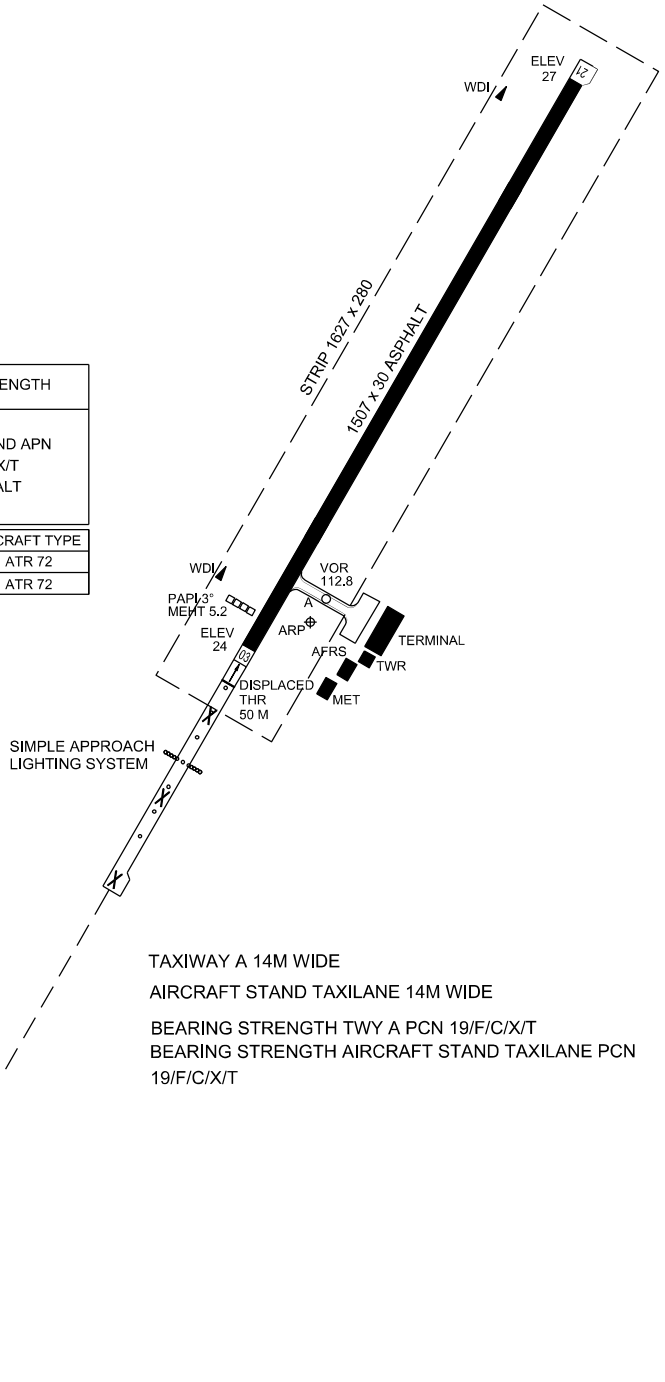

TAXIWAY A 14M WIDE
AIRCRAFT STAND TAXILANE 14M WIDE
BEARING STRENGTH TWY A PCN 19/F/C/X/T
BEARING STRENGTH AIRCRAFT STAND TAXILANE PCN 19/F/C/X/T

VOR/DME
VZU 112.8
CH 75X

NOT TO SCALE

LEGEND	
VOR CHECK POINT	

CHANGES: ADD MEHT VALUE,
ADD INFORMATION AIRCRAFT STAND TAXILANE
ADD INFORMATION BEARING STRENGTH