

**AERODROME GROUND
MOVEMENT CHART - ICAO
STAGE 3B (FM 20240607 TIL 20240612 EST)**

APRON ELEV
17 M

| | |
|--------------------|--|
| ACD 120.45 | |
| SMC 121.9 | |
| TWR 118.2 | |
| APP 124.2, 118.65, | |
| 135.25 | |
| FIS 126.1 | |
| ATIS 127.6 | |

**SUBANG/SULTAN
ABDUL AZIZ SHAH AIRPORT**

ANNUAL RATE OF CHANGE -0° 1' 18" W
ELEVATIONS IN METRES
BEARINGS ARE MAGNETIC

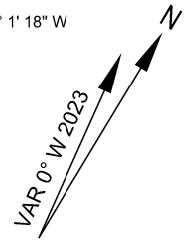

- TAXIWAYS A, W AND S1 25 M WIDE
- TAXIWAYS C, D, E, F, G, K, R, S,
AND T 23 M WIDE
- TAXIWAYS H, Y AND Z 26 M WIDE
- TAXIWAY J 38 M WIDE
- TAXIWAY L 27 M WIDE
- TAXIWAY M 24 M WIDE
- TAXIWAY N 29 M WIDE
- TAXIWAY P 48 M WIDE
- TAXIWAY Q 36 M WIDE
- TAXIWAY U 31 M WIDE
- TAXIWAY V 15 M WIDE
- TAXIWAY T1 44 M WIDE
- APRON TAXIWAY (MAIN APRON) 23 M WIDE

- BEARING STRENGTH TWY A PCN 87/F/A/W/T
- BEARING STRENGTH TWY C AND E PCN 86/F/A/W/T
- BEARING STRENGTH TWY D, F, G, J AND K PCN 100/F/A/W/T
- BEARING STRENGTH TWY H PCN 55/F/D/W/T
- BEARING STRENGTH TWY N PCN 76/F/C/W/T
- BEARING STRENGTH TWY W PCN 90/F/A/W/T
- BEARING STRENGTH TWY P PCN 81/F/C/W/T
- BEARING STRENGTH TWY U PCN 81/R/B/W/T
- BEARING STRENGTH TWY R PCN 98/F/A/W/T
- BEARING STRENGTH TWY T PCN 96/F/A/W/T
- BEARING STRENGTH TWY L PCN 65/R/C/W/T
- BEARING STRENGTH TWY M PCN 97/R/B/W/T
- BEARING STRENGTH TWY Q PCN 95/R/C/W/T
- BEARING STRENGTH TWY S PCN 100/R/C/W/T
- BEARING STRENGTH TWY S1 PCN 83/R/C/W/T
- BEARING STRENGTH TWY V PCN 45/F/C/X/U
- BEARING STRENGTH APN TWY PCN 56/R/C/X/U

- TAXIWAY EDGE LIGHTS ON A, C, E, H, K, N AND P CURVES
- TAXIWAY CENTRE LINE LIGHTS ON A, C, E, F, G, H, K,
N, W, P, S AND T

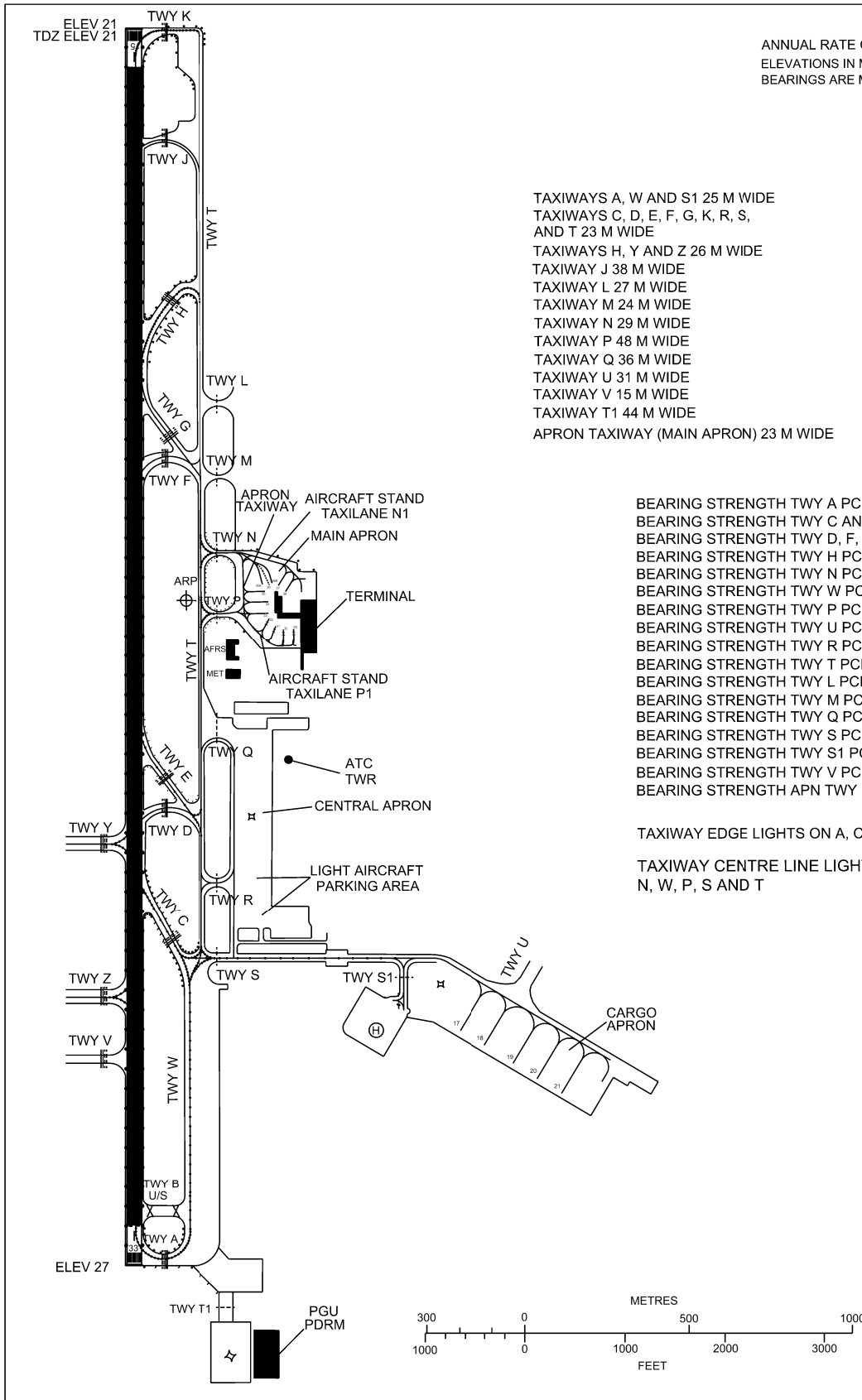

| LEGEND | |
|-------------------------------|-----|
| CONCRETE STRUCTURE | ▣ |
| RUNWAY-HOLDING POSITION | ▬ |
| INTERMEDIATE HOLDING POSITION | --- |
| HELICOPTER PARKING AREA | ⊕ |
| RUNWAY LIGHT | * |
| TAXIWAY LIGHT | ● |
| CLOSED MARKING | ⊗ |

CHANGES: ADD INFO ON AIRCRAFT STAND TAXILANE
CLOSED OPERATION FOR BAYS AND AIRCRAFT STAND TAXILANE