

**AIRCRAFT PARKING/
DOCKING CHART - ICAO
STAGE 1A (FM 20240201 TIL 20240314 EST)**

APRON ELEV
17 M

ACD 120.45	
SMC 121.9	
TWR 118.2	
APP 124.2,	118.65,
	135.25
FIS 126.1	
ATIS 127.6	

**SUBANG/SULTAN
ABDUL AZIZ SHAH AIRPORT**

AIRCRAFT PARKING / DOCKING STAND POSITION				
INS COORDINATES FOR AIRCRAFT STANDS		SURFACE & STRENGTH		AIRCRAFT TYPE
17	03° 07' 32.59" N 101° 33' 43.83" E	PCN 71/R/C/W/T		B772
18	03° 07' 32.59" N 101° 33' 46.16" E	PCN 61/R/C/W/T		B762
19	03° 07' 32.33" N 101° 33' 49.07" E	PCN 100/R/C/W/T		B744
20	03° 07' 32.33" N 101° 33' 51.30" E	PCN 100/R/C/W/T		MD 11
21	03° 07' 32.33" N 101° 33' 53.54" E	PCN 100/R/B/W/T		B744
29	03° 07' 57.80" N 101° 33' 11.31" E	PCN 56/R/C/X/U		AT76
30	03° 07' 57.23" N 101° 33' 10.35" E	PCN 56/R/C/X/U		AT76
31	03° 07' 57.17" N 101° 33' 09.45" E	PCN 56/R/C/X/U		AT76
32	03° 07' 57.49" N 101° 33' 08.44" E	PCN 56/R/C/X/U		AT76
33	03° 07' 57.98" N 101° 33' 08.10" E	PCN 56/R/C/X/U		AT76
34	03° 07' 59.06" N 101° 33' 07.47" E	PCN 56/R/C/X/U		AT76
35	03° 07' 59.89" N 101° 33' 06.61" E	PCN 56/R/C/X/U		AT76
36	03° 08' 00.70" N 101° 33' 06.68" E	PCN 56/R/C/X/U		B738
36A	03° 08' 00.40" N 101° 33' 05.99" E	PCN 56/R/C/X/U		AT76
36B	03° 08' 01.04" N 101° 33' 06.64" E	PCN 56/R/C/X/U		AT76
37	03° 08' 01.11" N 101° 33' 07.55" E	PCN 56/R/C/X/U		AT76
38	03° 08' 00.94" N 101° 33' 08.56" E	PCN 56/R/C/X/U		AT76
H1	03° 07' 30.08" N 101° 33' 39.66" E	CONCRETE - 11 TONNES		HELICOPTER (EC 725)
H2	03° 07' 28.91" N 101° 33' 39.88" E	CONCRETE - 6 TONNES		HELICOPTER (AW 139)
H3	03° 07' 27.72" N 101° 33' 39.88" E	CONCRETE - 11 TONNES		HELICOPTER (EC 725)
H4	03° 07' 27.71" N 101° 33' 37.66" E	CONCRETE - 11 TONNES		HELICOPTER (EC 725)
H5	03° 07' 28.90" N 101° 33' 37.65" E	CONCRETE - 6 TONNES		HELICOPTER (AW 139)
H6	03° 07' 30.07" N 101° 33' 37.64" E	CONCRETE - 11 TONNES		HELICOPTER (EC 725)

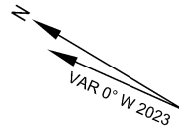

ANNUAL RATE OF CHANGE -0° 1' 18" W
ELEVATIONS IN METRES
BEARINGS ARE MAGNETIC

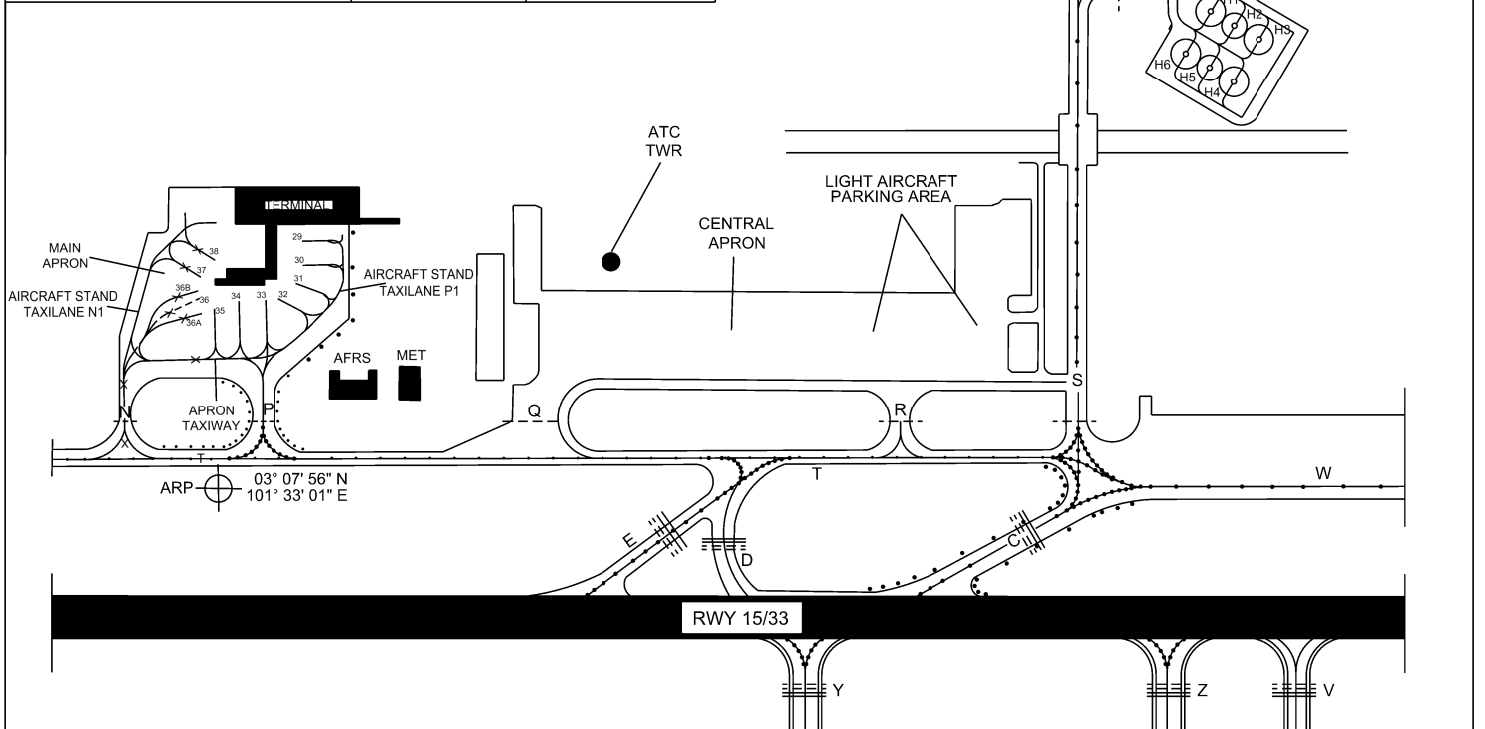

- TAXIWAYS A, W AND S1 25 M WIDE
- TAXIWAYS C, D, E, F, G, K, R, S AND T 23 M WIDE
- TAXIWAY H, Y AND Z 26 M WIDE
- TAXIWAY J 38 M WIDE
- TAXIWAY L 27 M WIDE
- TAXIWAY M 24 M WIDE
- TAXIWAY N 29 M WIDE
- TAXIWAY P 48 M WIDE
- TAXIWAY Q 36 M WIDE
- TAXIWAY U 31 M WIDE
- TAXIWAY V 15 M WIDE
- TAXIWAY T1 44 M WIDE
- APRON TAXIWAY (MAIN APRON) 23 M WIDE

- BEARING STRENGTH TWY A PCN 87/F/A/W/T
- BEARING STRENGTH TWY C AND E PCN 86/F/A/W/T
- BEARING STRENGTH TWY D, F, G, J AND K PCN 100/F/A/W/T
- BEARING STRENGTH TWY H PCN 55/F/D/W/T
- BEARING STRENGTH TWY N PCN 76/F/C/W/T
- BEARING STRENGTH TWY W PCN 90/F/A/W/T
- BEARING STRENGTH TWY P PCN 81/F/C/W/T
- BEARING STRENGTH TWY U PCN 81/R/B/W/T
- BEARING STRENGTH TWY R PCN 98/F/A/W/T
- BEARING STRENGTH TWY T PCN 96/F/A/W/T
- BEARING STRENGTH TWY L PCN 65/R/C/W/T
- BEARING STRENGTH TWY M PCN 97/R/B/W/T
- BEARING STRENGTH TWY Q PCN 95/R/C/W/T
- BEARING STRENGTH TWY S PCN 100/R/C/W/T
- BEARING STRENGTH TWY S1 PCN 83/R/C/W/T
- BEARING STRENGTH TWY V PCN 45/F/C/X/U
- BEARING STRENGTH APRON TWY PCN 56/R/C/X/U

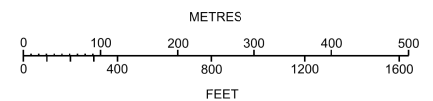

LEGEND	
AIRCRAFT STAND	15
RUNWAY-HOLDING POSITION	▬▬▬
INTERMEDIATE HOLDING POSITION	- - -
TAXIWAY LIGHT	●
CLOSED MARKING	X

CHANGES: ADD CLOSED MARKING AT LEGEND
ADD INFO ON AIRCRAFT STAND TAXILANE
CLOSED OPERATION FOR BAYS, AIRCRAFT STAND TAXILANE, APRON TAXIWAY AND TAXIWAY