

# AIRCRAFT PARKING/ DOCKING CHART - ICAO

APRON ELEV  
5 M

TWR	122.30
SMC	121.60
ATIS	128.65
TRAINING	129.10

# ALOR SETAR/SULTAN ABDUL HALIM AIRPORT

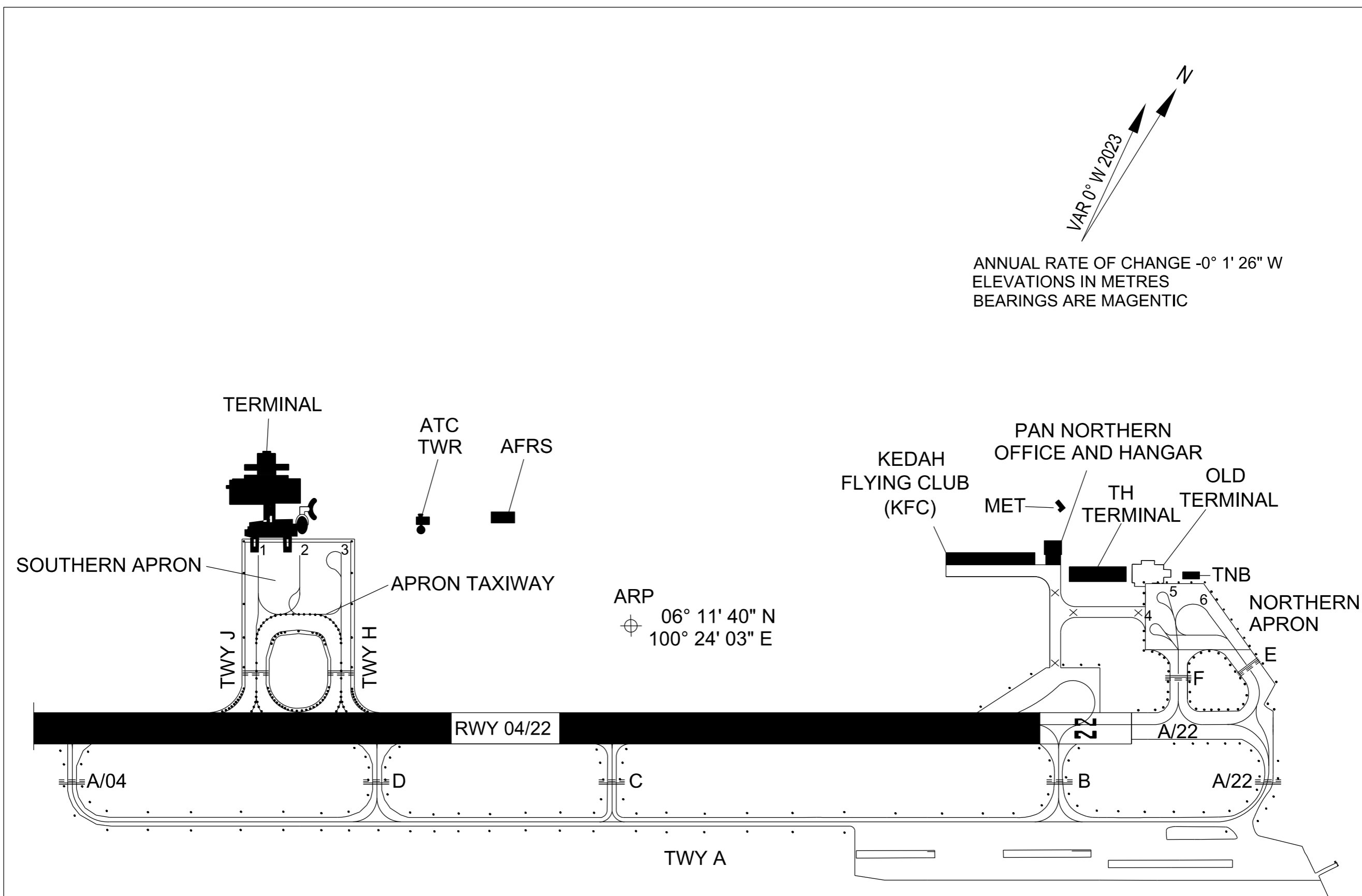

ANNUAL RATE OF CHANGE -0° 1' 26" W  
ELEVATIONS IN METRES  
BEARINGS ARE MAGNETIC

ARP  
06° 11' 40" N  
100° 24' 03" E

TAXIWAYS A, B, C AND D 15 M WIDE  
TAXIWAYS E, F, H AND J 23 M WIDE  
APRON TAXIWAY (SOUTHERN APRON) 23 M WIDE

BEARING STRENGTH TWY A, A/04, A/22, B, C AND D PCN 37/F/C/W/T  
BEARING STRENGTH TWY E AND F PCN 100/R/C/W/T  
BEARING STRENGTH TWY H AND J PCN 96/F/C/X/T  
BEARING STRENGTH APRON TAXIWAY (SOUTHERN APRON) PCN 96/R/C/X/T

TAXIWAY EDGE LIGHTS ON A, B, C, D, E, F, H AND J  
TAXIWAY CENTRELINE LIGHTS ON H AND J

AIRCRAFT STANDS 1 AND 2 APGS EQUIPPED

## AIRCRAFT PARKING/DOCKING STAND POSITION

INS COORDINATES FOR AIRCRAFT STANDS	SURFACE & STRENGTH	AIRCRAFT TYPE
SOUTHERN APRON		
1 06° 11' 27.73" N 100° 23' 45.48" E	PCN 75/R/C/X/T	B738, A320, A21N
2 06° 11' 29.36" N 100° 23' 46.96" E	PCN 75/R/C/X/T	A333, B738, A320, A21N
3 06° 11' 30.79" N 100° 23' 48.45" E	PCN 75/R/C/X/T	AT75, AT76
NORTHERN APRON		
4 06° 12' 02.19" N 100° 24' 23.03" E	PCN 100/R/C/W/T	B738
5 06° 12' 03.52" N 100° 24' 21.89" E	PCN 100/R/C/W/T	B738
6 06° 12' 04.58" N 100° 24' 24.45" E	PCN 100/R/C/W/T	B738

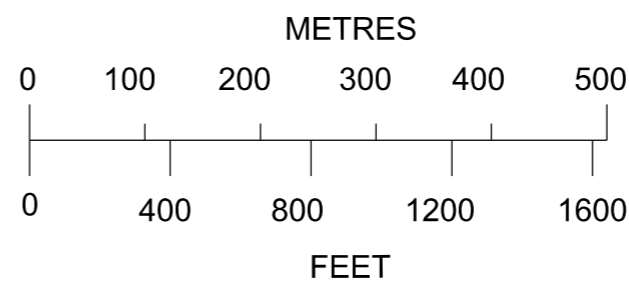

LEGEND	
AIRCRAFT STAND	6
TAXIWAY LIGHT	•
RUNWAY-HOLDING POSITION	=====
CLOSED MARKING	×

**CHANGES:** ADJUST BAR SCALE  
DELETE INFORMATION TWY K AND TWY L  
INFORMATION ON MAGNETIC VARIATION AND ANNUAL CHANGE  
INFORMATION ON BEARING STRENGTH  
INFORMATION ON AIRCRAFT STANDS  
ADD INFORMATION ON TAXIWAY EDGE LIGHT  
ADD INFORMATION ON RUNWAY-HOLDING POSITION MARKING  
ADD INFORMATION ON INS COORDINATES FOR AIRCRAFT STANDS