

**AIRCRAFT PARKING/  
DOCKING CHART - ICAO**

APRON ELEV  
4 M

TWR 121.1  
SMC 121.6  
121.9  
ATIS 126.4

**PENANG/PENANG  
INTERNATIONAL AIRPORT**

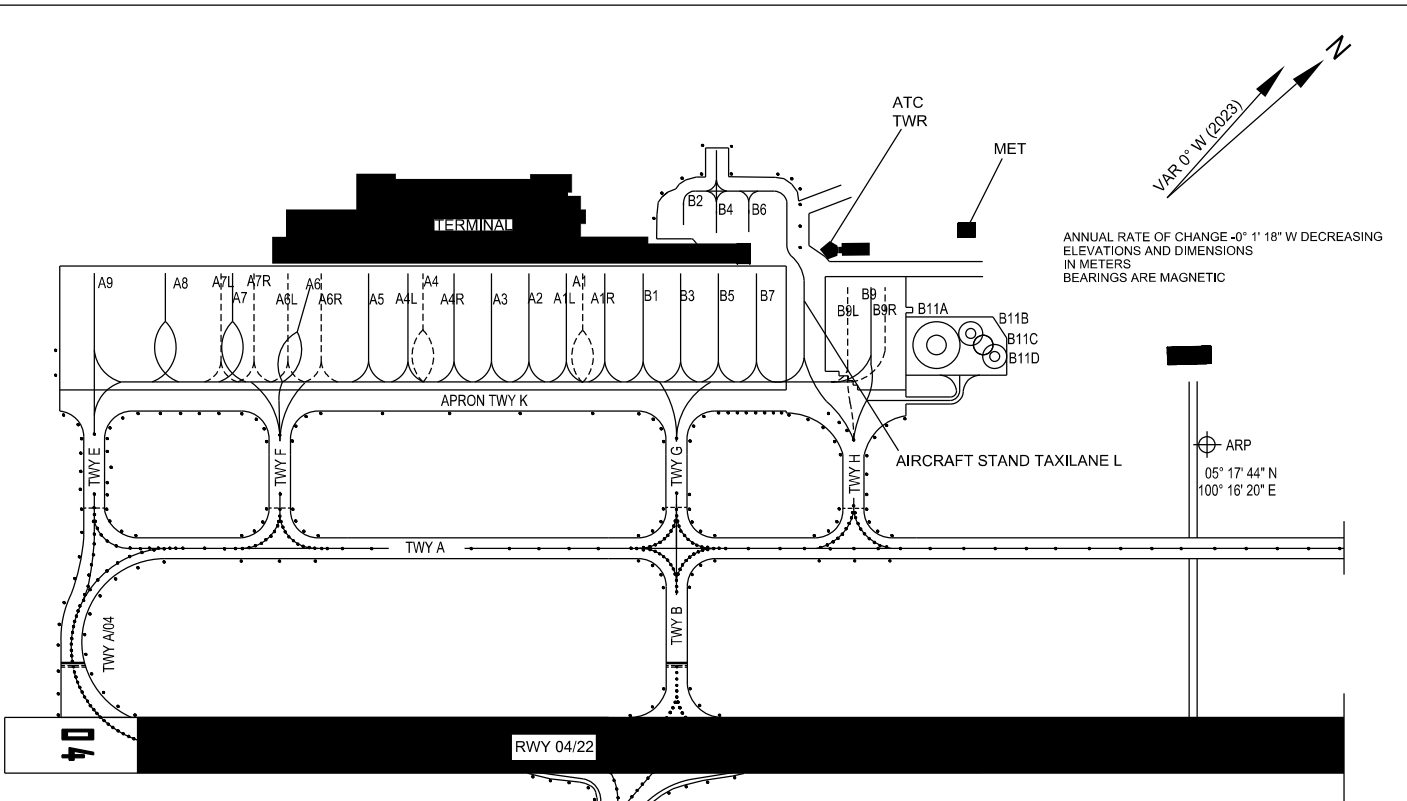

ANNUAL RATE OF CHANGE -0° 1' 18" W DECREASING  
ELEVATIONS AND DIMENSIONS  
IN METERS  
BEARINGS ARE MAGNETIC

ARP  
05° 17' 44" N  
100° 16' 20" E

**04**

RWY 04/22

AIRCRAFT STAND TAXILANE J1

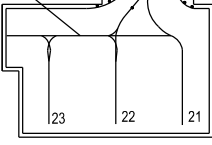

SECOND CARGO COMPLEX

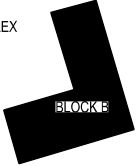

- TAXIWAY A, A04, A22 AND C 23 M WIDE
- TAXIWAY B, D, E, F, G AND H 35 M WIDE
- TAXIWAY J 24 M WIDE
- APRON TAXIWAY K 23 M WIDE
- AIRCRAFT STAND TAXILANE J1 23 M WIDE
- AIRCRAFT STAND TAXILANE L 15 M WIDE

RESTRICTED ROUTE FOR B747-800 OPERATIONS ARE  
TAXIWAYS A, H, A04, A22 AND PARKING IS BAY B9

- BEARING STRENGTH TWY A PCN 74/F/A/W/T
- BEARING STRENGTH TWY A/04 PCN 74/R/A/W/T
- BEARING STRENGTH TWY A/22 PCN 74/F/A/W/T
- BEARING STRENGTH TWY B PCN 62/R/A/W/T
- BEARING STRENGTH TWY C PCN 63/F/A/W/T
- BEARING STRENGTH TWY D PCN 88/F/A/W/T
- BEARING STRENGTH TWY E PCN 43/F/A/W/T
- BEARING STRENGTH TWY F PCN 54/F/A/W/T
- BEARING STRENGTH TWY G PCN 55/F/A/W/T
- BEARING STRENGTH TWY H PCN 67/F/A/W/T
- BEARING STRENGTH TWY J PCN 67/R/B/W/T
- BEARING STRENGTH APRON TWY K PCN 92/R/D/W/T
- BEARING STRENGTH AIRCRAFT STAND TAXILANE J1 PCN 67/R/B/W/T
- BEARING STRENGTH AIRCRAFT STAND TAXILANE L PCN 67/F/A/W/T

AIRCRAFT STANDS A1, A1R, A1L, A3, A4, A4R, A4L, A5, A6, A6R FMT APIS ++ EQUIPPED  
AIRCRAFT STANDS A2, B1, B3, B5, B7 SAFEGATE EQUIPPED

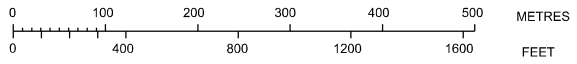

LEGEND	
AIRCRAFT STAND	23
TAXIWAY LIGHT	•
RUNWAY-HOLDING POSITION	=====
INTERMEDIATE HOLDING POSITION	----

**CHANGES:** ADD INFO ON TAXIWAY  
ADJUST BAR SCALE  
INFO ON APRON ELEVATION  
INFO ON AIRCRAFT STAND  
INFO ON MAGNETIC VARIATION AND ANNUAL CHANGE  
PATTERN RUNWAY-HOLDING POSITION  
UPDATE INFO ON VDGs TYPE AT AIRCRAFT STAND