

**AERODROME/HELIPORT
CHART - ICAO**

01° 38' 26" N
103° 40' 13" E

ELEV 41 M

SMC	121.80 MHZ
TWR	118.15 MHZ
APP	124.70 MHZ
	121.05 MHZ
ATIS	123.05 MHZ

**JOHOR BAHRU/
SENAI INTERNATIONAL
AIRPORT**

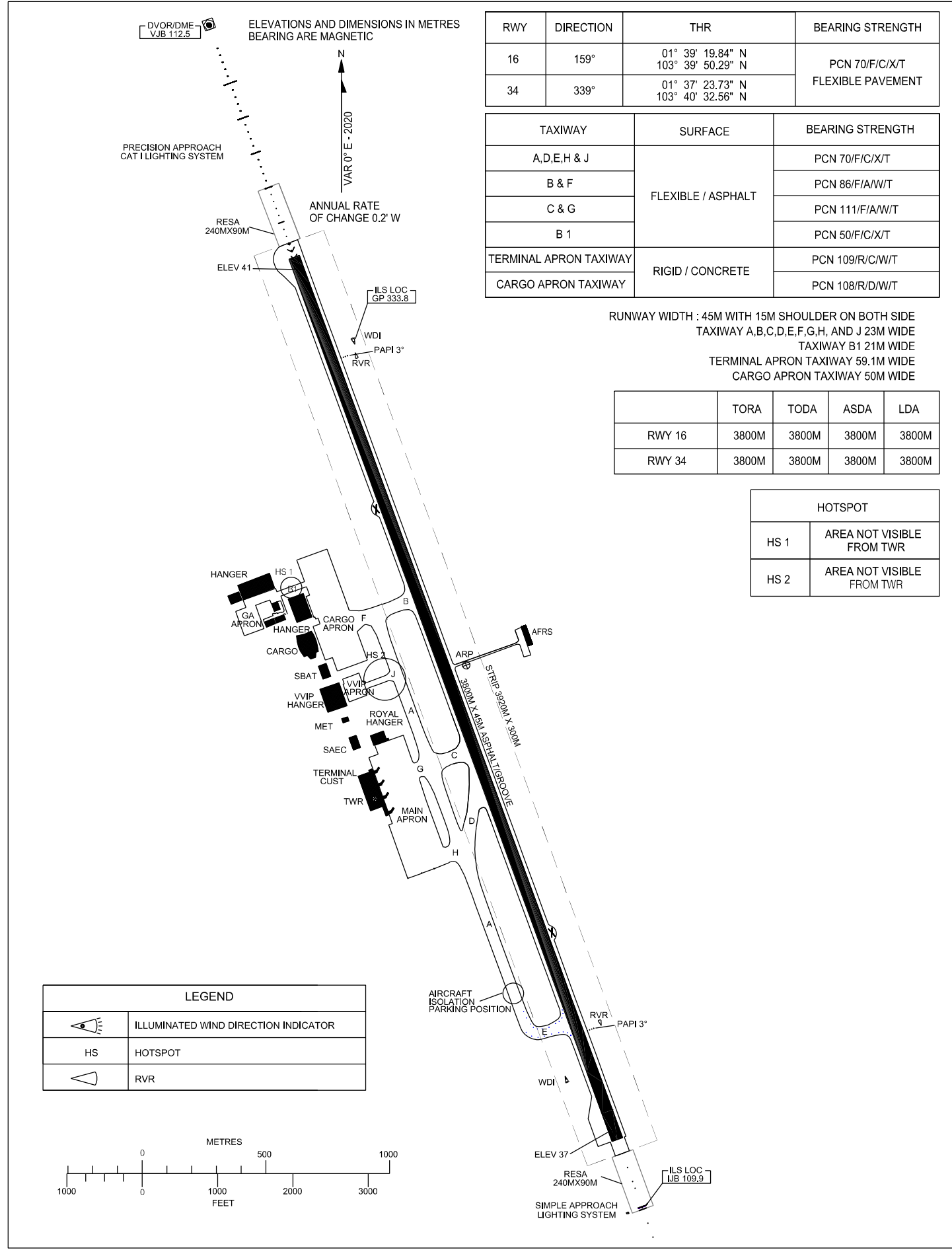

RWY	DIRECTION	THR	BEARING STRENGTH
16	159°	01° 39' 19.84" N 103° 39' 50.29" N	PCN 70/F/C/X/T FLEXIBLE PAVEMENT
34	339°	01° 37' 23.73" N 103° 40' 32.56" N	

TAXIWAY	SURFACE	BEARING STRENGTH
A, D, E, H & J	FLEXIBLE / ASPHALT	PCN 70/F/C/X/T
B & F		PCN 86/F/A/W/T
C & G		PCN 111/F/A/W/T
B 1		PCN 50/F/C/X/T
TERMINAL APRON TAXIWAY	RIGID / CONCRETE	PCN 109/R/C/W/T
CARGO APRON TAXIWAY		PCN 108/R/D/W/T

RUNWAY WIDTH : 45M WITH 15M SHOULDER ON BOTH SIDE
 TAXIWAY A,B,C,D,E,F,G,H, AND J 23M WIDE
 TAXIWAY B1 21M WIDE
 TERMINAL APRON TAXIWAY 59.1M WIDE
 CARGO APRON TAXIWAY 50M WIDE

	TORA	TODA	ASDA	LDA
RWY 16	3800M	3800M	3800M	3800M
RWY 34	3800M	3800M	3800M	3800M

HOTSPOT	
HS 1	AREA NOT VISIBLE FROM TWR
HS 2	AREA NOT VISIBLE FROM TWR

LEGEND	
	ILLUMINATED WIND DIRECTION INDICATOR
	HOTSPOT
	RVR

