

**AIRCRAFT PARKING/
DOCKING CHART - ICAO
KLIA2 TERMINAL**

APRON ELEV
10 M

RWY 32L/14R	
TWR	118.500
GND	121.800
GND	122.525

KLIA2 TERMINAL	
GND	121.725
GND	122.550
GND	130.750

ACD	
	126.0
	128.15

**SEPANG/
KL INTERNATIONAL
AIRPORT**

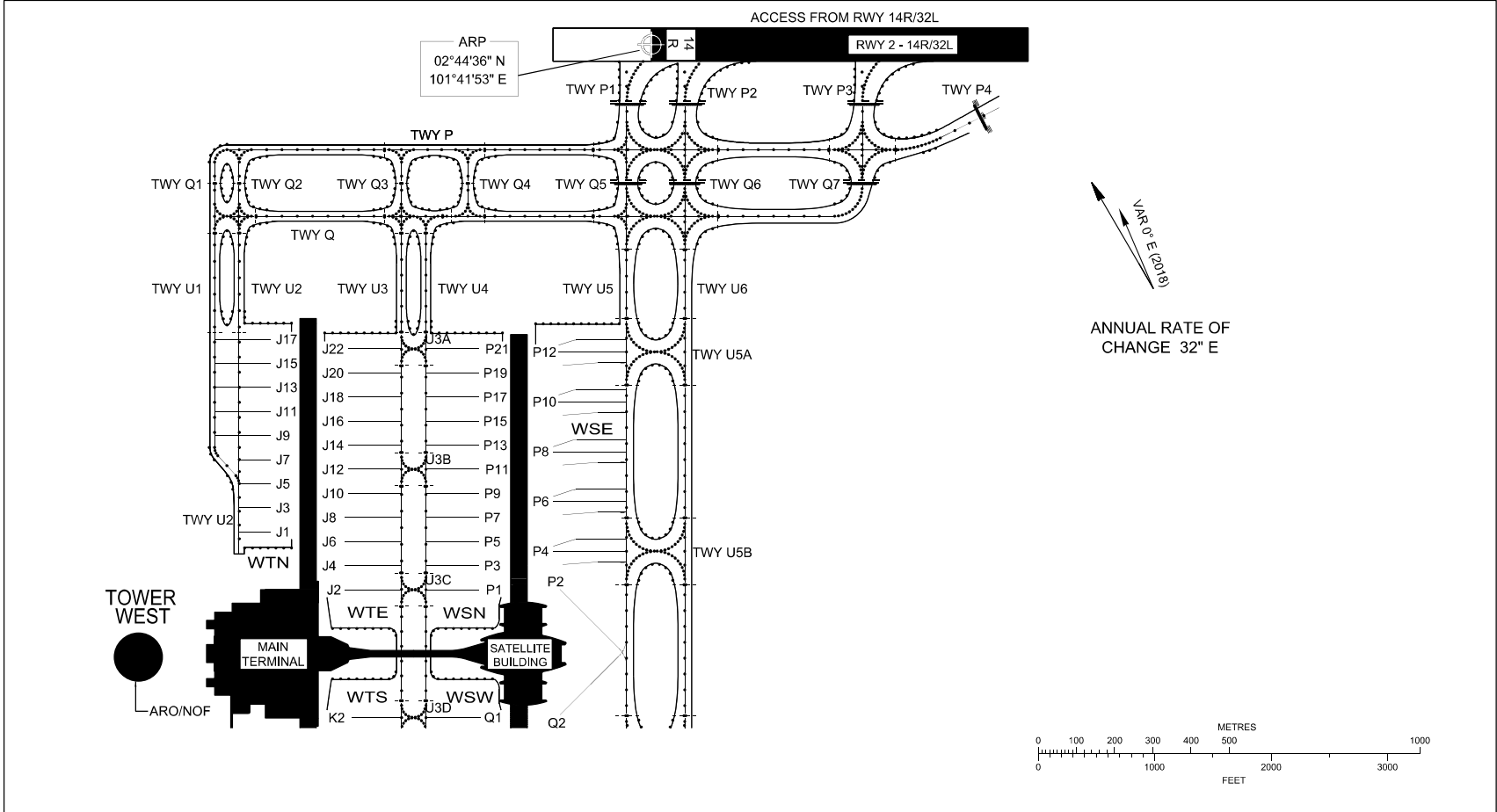

CHANGES : ADD AIRWAYS CLEARANCE DELIVERY (ACD) FREQUENCY.