AIP SUPPLEMENT MALAYSIA

PHONE: 6-03-8871 4000
FAX: 6-03-8881 0530
AFTN: WMKKYAYS

AERONAUTICAL INFORMATION SERVICES
DEPARTMENT OF CIVIL AVIATION
NO. 27, PERSIARAN PERDANA
LEVEL 1-4, PODIUM BLOCK,PRECINCT 4,
62618 PUTRAJAYA,
MALAYSIA

23/2015
01 OCT

KUALA LUMPUR FLIGHT INFORMATION REGION PENANG INTERNATIONAL AIRPORT REHABILITATION WORKS OF AIRFIELD PAVEMENT WORK SCHEDULE AND MOVEMENT AREAS RESTRICTIONS

1 INTRODUCTION

- 1.1 The airfield pavement at Penang International Airport is undergoing rehabilitation works. The works involve the rehabilitation of identified localized areas on Runway, Parallel Taxiway A/04, A/22, A/C and A/F intersection and apron taxiway areas. The working areas for the rehabilitation exercise is provided in Attachment "1" of this AIP Supplement.

2 PURPOSE

- 2.1 The purpose of this AIP Supplement is to notify the aviation industry of the of the schedule and the extent of the work areas due to construction activities on the aircraft movement areas, as well as the changes and restrictions on the movement areas at the Parking Apron and Taxiways of Penang International Airport. These include closures to portion[s] of taxiway[s], and closures to portion[s] of apron.
- 2.2 Construction works are expected to take thirteen (13) months.

3 WORK PHASES AND TEMPORARY CLOSURE OF MOVEMENT AREAS

- 3.1 The tentative works activities are divided into 9 phases as per the general sequence outlined in Table 3.1. Refer to Appendix 1 – Appendix 9 of this Supplement for detail. Dates and duration contained in Table 3.1 are indicative. Exact dates and times will be circulated by NOTAM with reference to this supplement

Table 3.1 – Works Phases And Temporary Closure Of Movement Areas

Phases	Location	Duration	Activity
Phase 1A Phase 1B	Bay A8, A9 Taxiway E	25 days	1. Closure of existing Bay A8 and A9. 2. Closure of Taxiway E
Phase 2	Bay A7, A8	10 days	1. Closure of existing Bay A7 and A8 2. Reopening of Taxiway E. 3. Reopening of Bay A9.
Phase 3A	Bay A7, A6	20 days	1. Closure of existing Bay A7, A6L, A6 and A6R. 2. Reopening of Bay A7 and A8
Phase 3B	Taxiway F Intersection A/F	35 days	1. Closure of Taxiway F. 2. Closure of Taxiway Intersection A/F 3. Reopening of Bay A7, A6L, A6 and A6R. 4. Reopening of Bay A8.
Phase 4	Bay A5, A4	19 days	1. Closure of existing Bay A5, A4L, A4 and A4R. 2. Reopening of Taxiway F. 3. Reopening of Taxiway Intersection A/F
Phase 5	Bay A3 – B7	55 days	1. Re-alignment of apron taxiway from existing Bay A3 to B7 to new temporary apron taxiway. 2. Reopening of Bay A5, A4L, A4 and A4R. 3. Closure of existing Bay A3 – B7. 4. Closure of Taxiway G
Phase 6	Runway	79 days	1. Runway resurfacing during closure hours. 2. Shifting of temporary apron taxiway to permanent existing Bay A3 to B7. 3. Reopening of Bay A3 – B7. 4. Reopening of Taxiway G
Phase 7	Taxiway A/04	19 days	1. Closure of Taxiway A/04. 2. Wide body aircrafts to land from RWY 04 direction and take-off from RWY 22 direction.
Phase 8	Taxiway A/22	60 days	1. Closure of Taxiway A/22. 2. Reopening of Taxiway A/04. 3. Wide body aircrafts to land from RWY 22 direction and take-off from RWY 04 direction.
Phase 9	Intersection A/C	20 days	1. Rehabilitation works at Taxiway A/C during closure hours. 2. Reopening of Taxiway A/22.

4 CONSTRUCTION WORKING HOURS FOR RUNWAY, TAXIWAYS AND APRON TAXIWAYS

PHASE 1 TO 4: APRON TAXIWAY AT BAY A9 –A4 (WIDE-BODY)

- 4.1 Construction works for Apron Taxiway will be carried out progressively in order to minimize disruptions to the operation. Two (2) bays will be un-available at any one time.
- 4.2 Construction works at Taxiway E will be done concurrent with apron taxiway Bay A8 and A9.
- 4.3 Construction works at Taxiway F and Taxiway Intersection A/F will be carried out only once works at apron taxiway Bay A6 and A7 is completed.
- 4.4 Construction works will be done 24 hours within the closed areas.

PHASE 5: APRON TAXIWAY AT BAY A3 – B7 (NARROW-BODY)

- 4.5 Only once all construction works within wide-body apron-taxiway areas from Bay A9 to Bay A4 are completed, the works will proceed to the narrow-body area from Bay A3 to Bay B7.
- 4.6 Apron taxiway from Bay A3 – B7 for narrow-body aircraft will be temporarily re-aligned. The existing apron taxiway area will be permanently cordoned/barricaded for construction works.
- 4.7 Construction works will be done 24 hours at the closed Apron Taxiway.

PHASE 6: RUNWAY

- 4.8 Construction works at localized areas on the Runway will be carried out during the Airport non-operational hours from 12.00 midnight to 5.00 a.m. local time. The Runway will be closed from 12.00 midnight to 6.00 a.m. local time.

PHASE 7 TO 9: TAXIWAY A

- 4.9 Taxiway A/04 will be closed for construction within the estimated duration of 16 days as indicated in Table 3.1. Construction works will be done 24 hours at the closed Taxiway area. During this time, landing and take-off from Rwy 22 for wide-body aircraft will not be permitted.
- 4.10 Works at Taxiway A/04 must be completed before construction works can proceed at A/22 area. The estimated duration of closure for Taxiway A/22 is 60 days as indicated in Table 3.1. Construction works will be done 24 hours at the closed Taxiway area. During this time, landing and take-off from Rwy 04 for wide-body aircraft will not be permitted.
- 4.11 Construction works for Taxiway A/C intersection will be carried out during the Airport non-operational hours from 12.00 midnight to 5.00 a.m. local time. Taxiway A/C intersection will be closed from 12.00 midnight to 6.00 a.m. local time.

5 MOVEMENT AREAS RESTRICTIONS

- 5.1 The restricted movements areas and available movement areas during the construction activity for each Work Phase is provided in Attachment “2” of this Supplement.

6 REGULATIONS ON MOVEMENT AREAS

- 6.1 No aircraft movement is allowed at closed portions of apron taxiway, parking bays and taxiways.
- 6.2 The routes to be used by aircraft when taxiing into, on and out of the Apron will be specified by Air Traffic Control. The issuance by Air Traffic Control of a taxi route to an aircraft does not relieve the pilot-in-command of the responsibility to maintain separation with other aircraft on the movement area or to comply with Air Traffic Control directions intended to regulate aircraft movement.

7 PRECAUTIONS

- 7.1 During the construction period, pilots are advised to take note of the precautions on the presence of open excavation, workers, construction materials and construction equipment, particularly when taxiing on Apron Taxiway adjacent to Bay A6 and A7 when Taxiway F works is in progress, and Bay A3 to B7 when works within the cordoned/barricaded areas are in progress, as shown in Appendix 3B and Appendix 5.

8 IMPLEMENTATION

- 8.1 This AIP Supplement and relevant charts will be applicable during the whole of the rehabilitation.
- 8.2 Trigger NOTAM will be issued notifying the effective date of implementation.

9 CANCELLATION

9.1 This AIP Supplement will remain current until the information is published in AIP Malaysia.

DATO' SRI AZHARUDDIN ABDUL RAHMAN
Director General
Department of Civil Aviation
Malaysia

PENANG INTERNATIONAL AIRPORT PAVEMENT REHABILITATION CONSTRUCTION WORKS AREAS

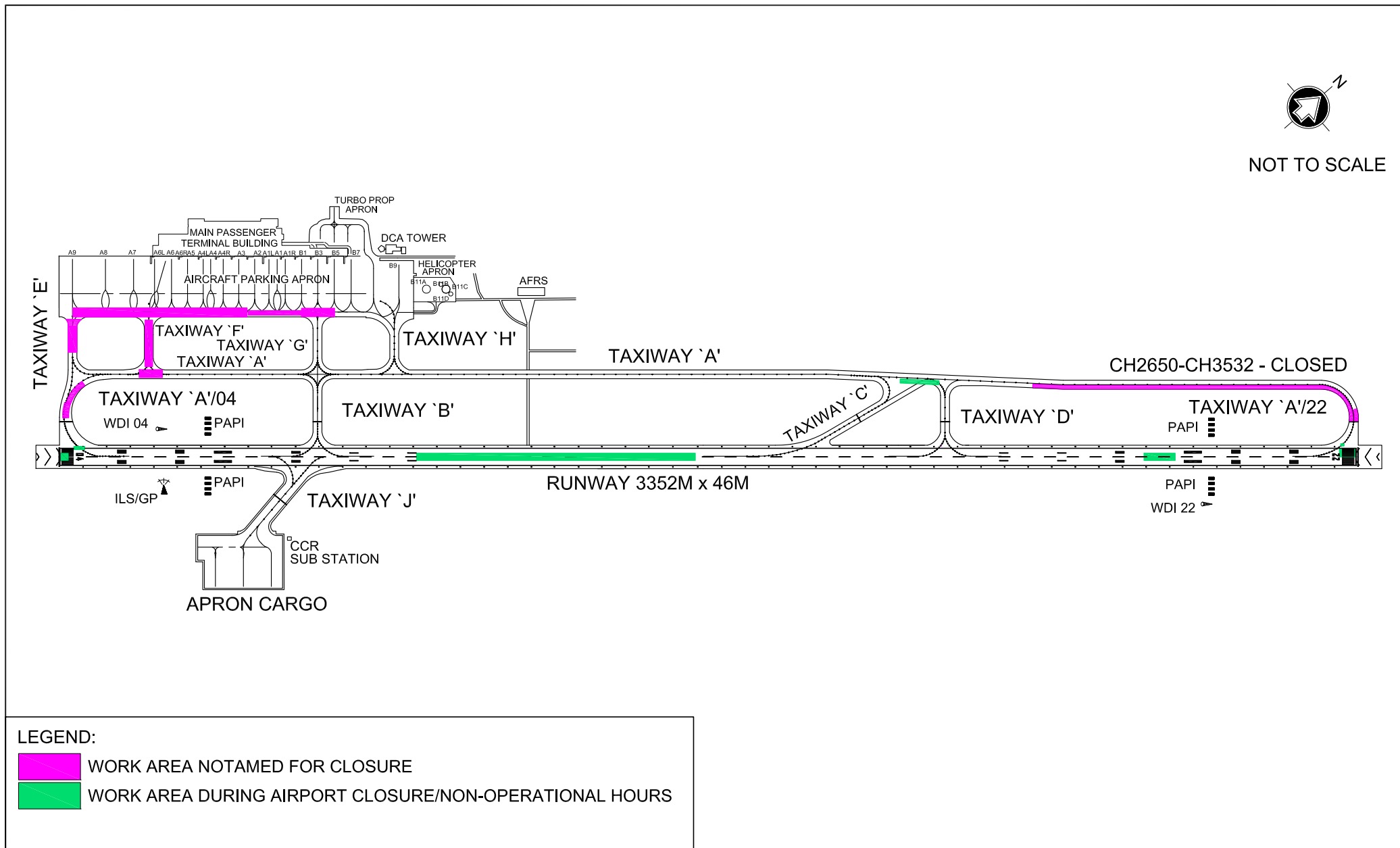
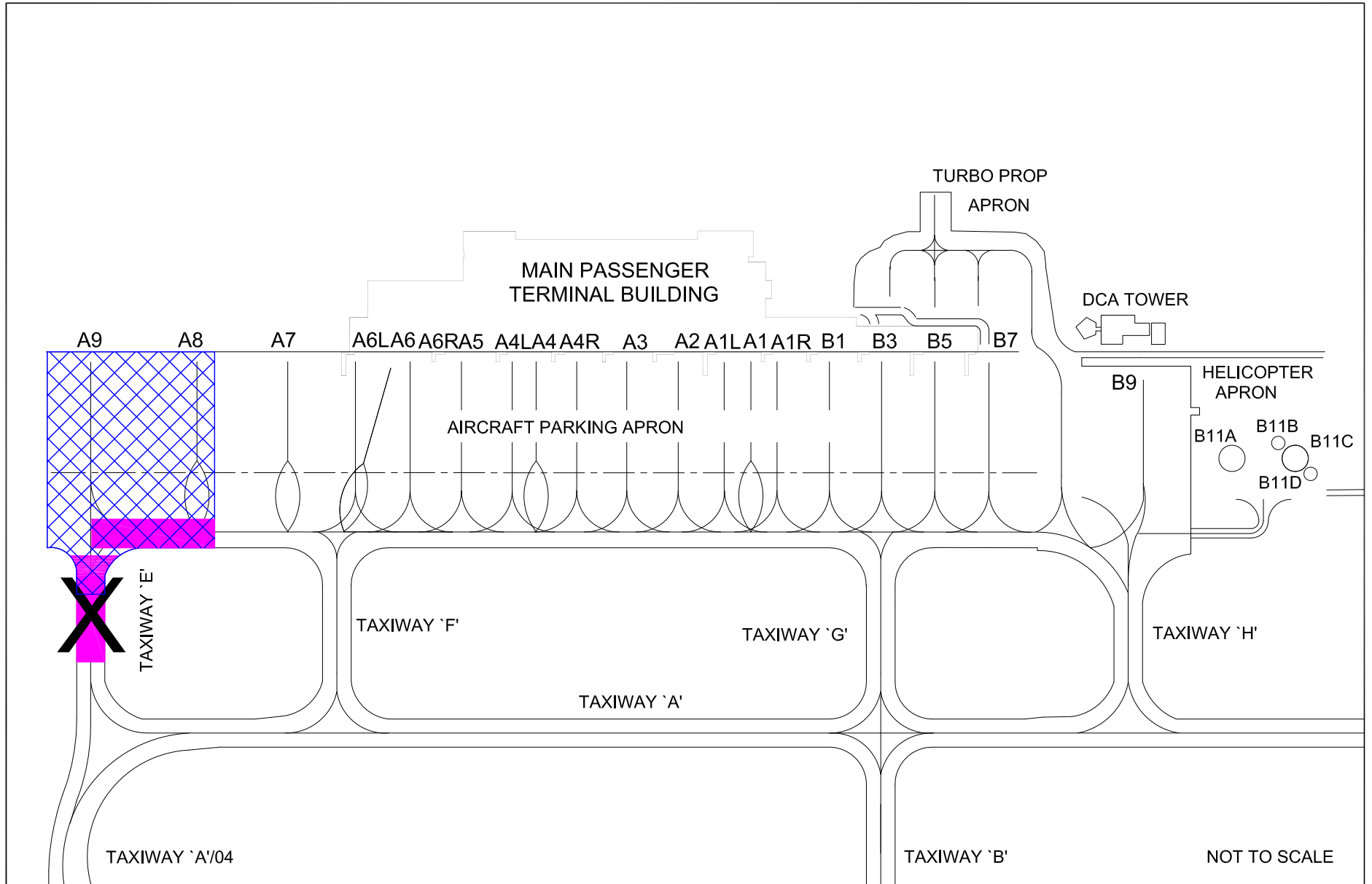

Table 1: Restricted and Available Movement Areas

Works Phase	Activity	Availability			
		Wide-Body Bay	Narrow Body Bay	MARS	Runway/Taxiways
PHASE 1	Closure of bay A8 & A9 Closure of Taxiway E	Five (5) wide-body stand A7, A6, A4, A1, B9	Thirteen (13) narrow-body stand A6R, A6L, A5, A4R, A4L, A3, A2, A1R, A1L, B1, B3, B5, B7	A6, A4, A1	Wide and narrow body entrance to parking apron via Taxiway F, G and H Taxiway E not available
PHASE 2	Closure of bay of A7 & A8	Five (5) wide-body stand A9, A6, A4, A1, B9	Thirteen (13) narrow-body stand A6R, A6L, A5, A4R, A4L, A3, A2, A1R, A1L, B1, B3, B5, B7	A6, A4, A1	Wide and narrow body entrance to parking apron via Taxiway E, F, G and H
PHASE 3A	Closure of bay of A6 & A7	Five (5) wide-body stand A9, A8, A4, A1, B9	Eleven (11) narrow-body stand A5, A4R, A4L, A3, A2, A1R, A1L, B1, B3, B5, B7	A6, A4, A1	Wide and narrow body entrance to parking apron via Taxiway E, F, G and H Taxiway F not available
PHASE 3B	Closure of Taxiway F and Taxiway Intersection A/F	Five (5) wide-body stand A9, A8, A7, A6, A4, A1, B9	Eleven (11) narrow-body stand A5, A4R, A4L, A3, A2, A1R, A1L, B1, B3, B5, B7	A6, A4, A1	Wide and narrow body entrance via Taxiway E, G and H Taxiway F and Taxiway Intersection A/F not available
PHASE 4	Closure of Bay A4, A5	Six (6) wide-body stand A9, A8, A7, A6, A1, B9	Ten (10) narrow-body stand A6R, A6L, A3, A2, A1R, A1L, B1, B3, B5, B7	A6, A1	Wide and Narrow Body entrance via Taxiway E, F, G and H
PHASE 5	Closure of Bay A3 – B5	Six (6) wide-body stand A9, A8, A7, A6, A4, B9	Thirteen (13) narrow-body stand A5, A6R, A6L, A4R, A4L, A3, A2, A2, A1R, A1L, B1, B3, B5, B7	A6	Dedicated Wide-Body entrance via Taxiway E & F Dedicated Narrow-Body entrance via Taxiway H, E & F Temporary Re-alignment of Apron Taxiway for Narrow-Body from Bay A3 – B7 Taxiway G not available

Works Phase	Activity	Availability			
		Wide-Body Bay	Narrow Body Bay	MARS	Runway/Taxiways
PHASE 6	Resurfacing of Runway 04/22 during Airport non-operational/closure hours	Seven (7) wide-body stand A9, A8, A7, A6, A4, A1, B9	Thirteen (13) narrow-body stand A6R, A6L, A5, A4R, A4L, A3, A2, A1R, A1L, B1, B3, B5, B7	A6, A4, A1	Parallel Taxiway A Taxiway B,C.D.E,F, G,H, J
PHASE 7	Closure of Taxiway A/04	Seven (7) wide-body stand A9, A8, A7, A6, A4, A1, B9	Thirteen (13) narrow-body stand A6R, A6L, A5, A4R, A4L, A3, A2, A1R, A1L, B1, B3, B5, B7	A6, A4, A1	Landing only from Rwy 04 and take-off only from Rwy 22 for Wide-Body aircraft. Partial Parallel Taxiway A Taxiway B,C.D.E,F, G,H, J
PHASE 8	Closure of Taxiway A/22 (CH2650 – CH3532)	Seven (7) wide-body stand A9, A8, A7, A6, A4, A1, B9	Thirteen (13) narrow-body stand A6R, A6L, A5, A4R, A4L, A3, A2, A1R, A1L, B1, B3, B5, B7	A6, A4, A1	Landing only from Rwy 22 and take only from Rwy 04 for Wide-Body Aircraft. Partial Parallel Taxiway A (CH0000 – CH2650) Taxiway B,C.D.E,F, G,H, J
PHASE 9	Taxiway A/C Intersection during Airport non-operational/closure hours	SEVEN (7) WIDE-BODY STAND A9, A8, A7, A6, A4, A1, B9	THIRTEEN (13) NARROW-BODY STAND A6R, A6L, A5, A4R, A4L, A3, A2, A1R, A1L, B1, B3, B5, B7	A6, A4, A1	Parallel Taxiway A Taxiway B,C.D.E,F, G,H, J

PENANG INTERNATIONAL AIRPORT PAVEMENT REHABILITATION CLOSURE OF BAY A9, A8 AND TAXIWAY E PHASE 1 : DURATION 25 DAYS



PENANG INTERNATIONAL AIRPORT
PAVEMENT REHABILITATION
CLOSURE OF BAY A8, A7
PHASE 2 : DURATION 10 DAYS

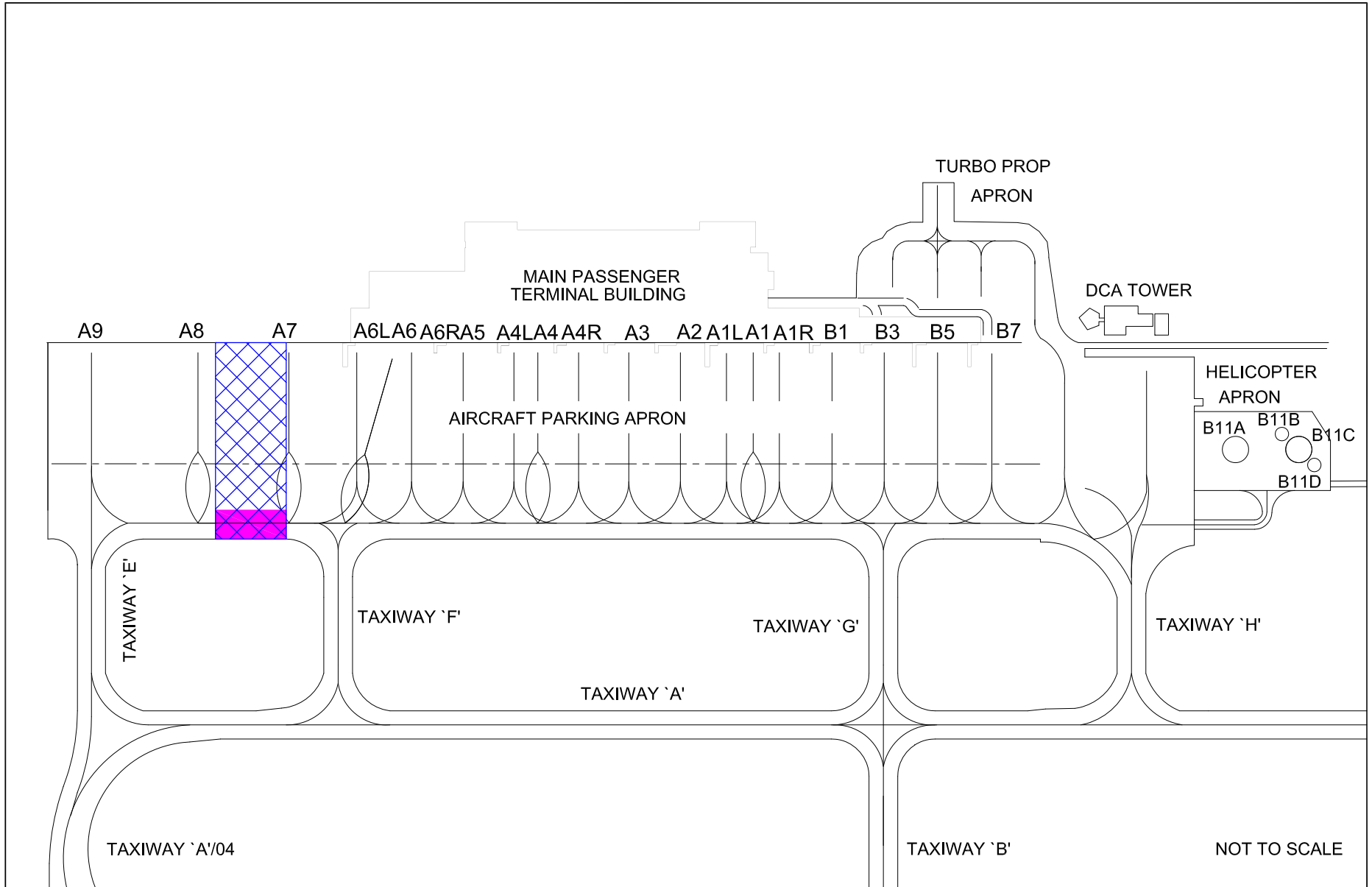

PENANG INTERNATIONAL AIRPORT AIRFIELD
PAVEMENT REHABILITATION CLOSURE OF BAY A7, A6
PHASE 3A : DURATION 20 DAYS

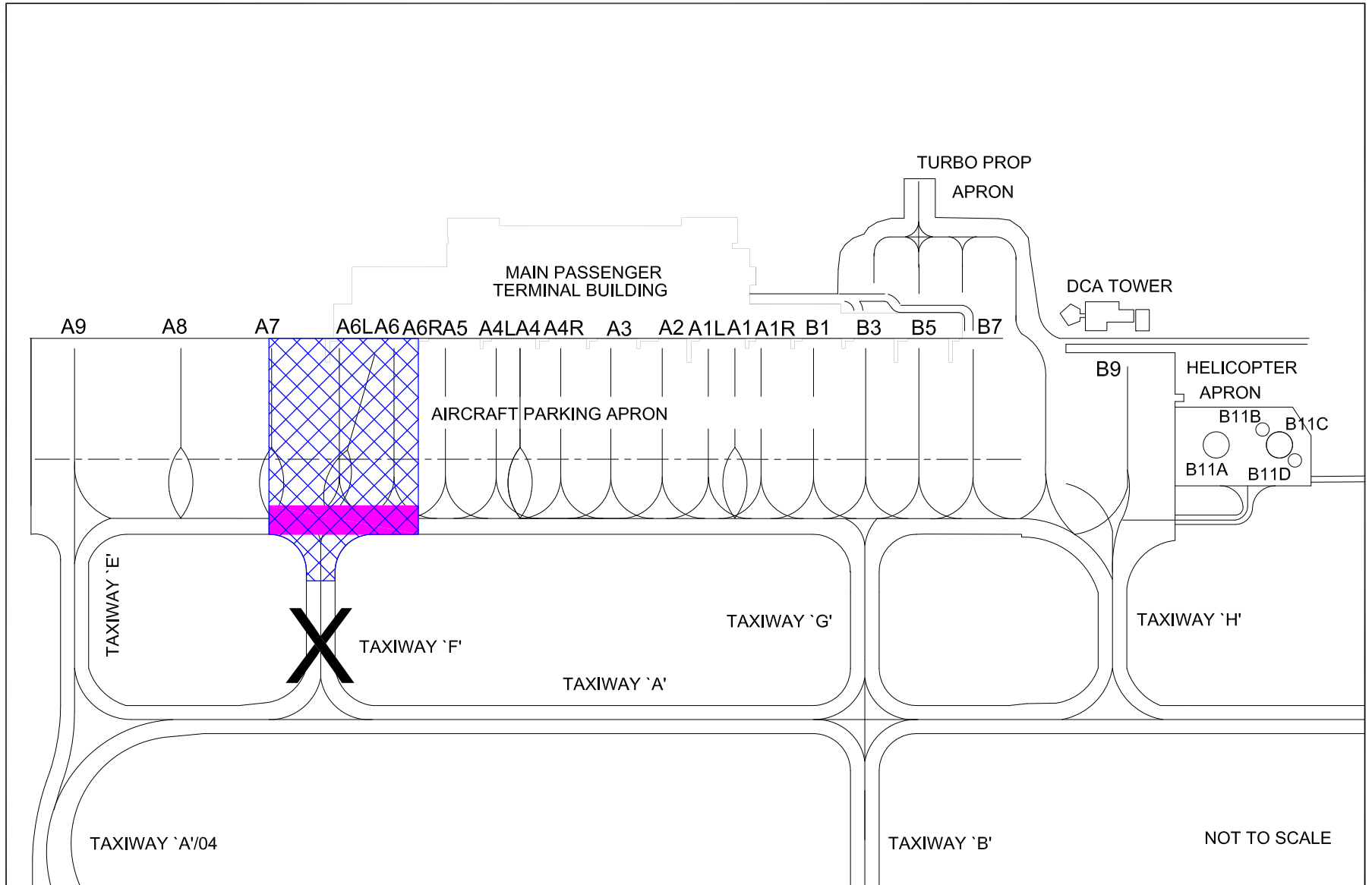

PENANG INTERNATIONAL AIRPORT AIRFIELD
PAVEMENT REHABILITATION CLOSURE OF TAXIWAY F AND INTERSECTION A/F
PHASE 3B : DURATION 35 DAYS

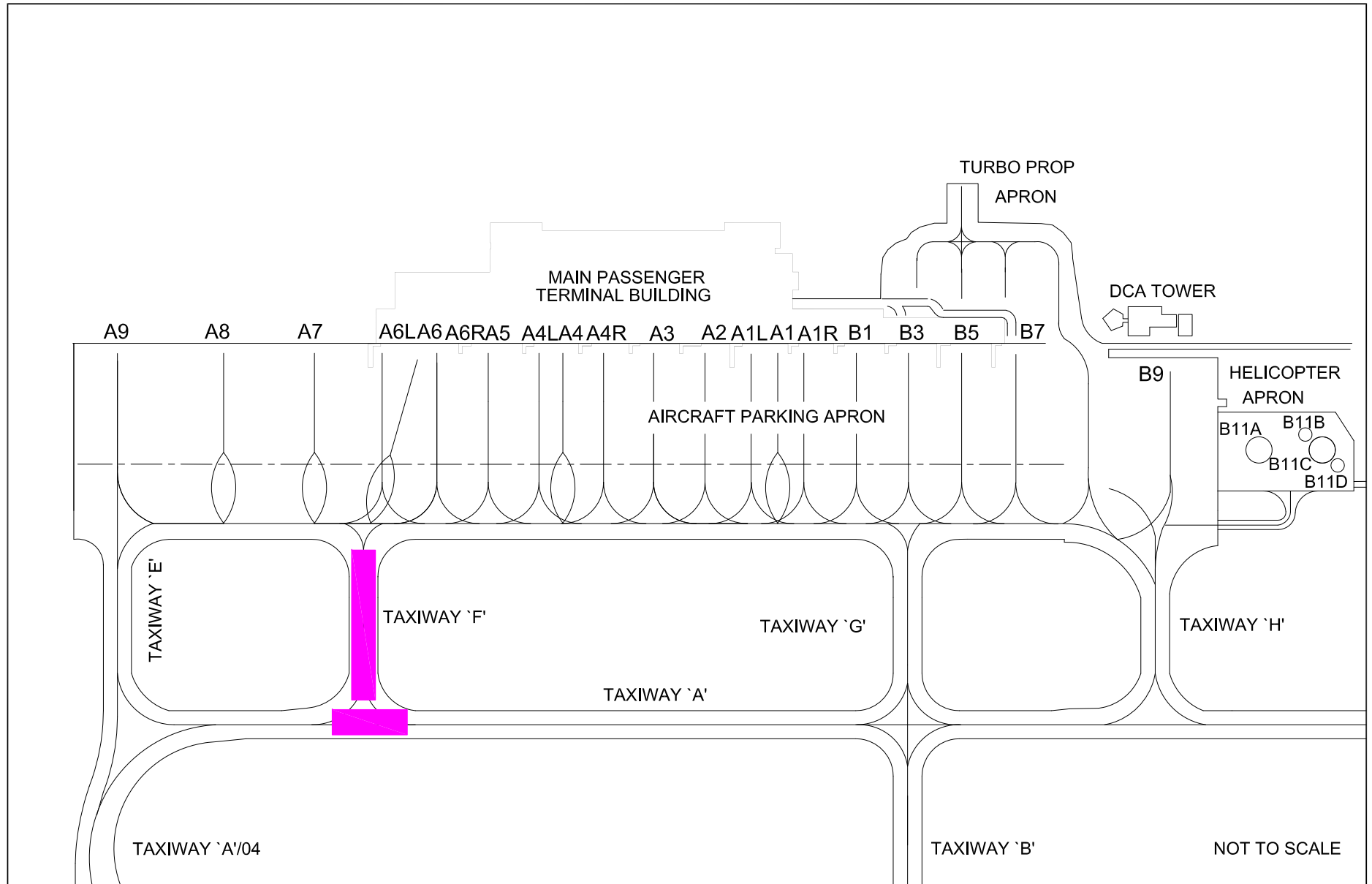

PENANG INTERNATIONAL AIRPORT AIRFIELD
PAVEMENT REHABILITATION CLOSURE OF BAY A5, A4
PHASE 4 : DURATION 19 DAYS

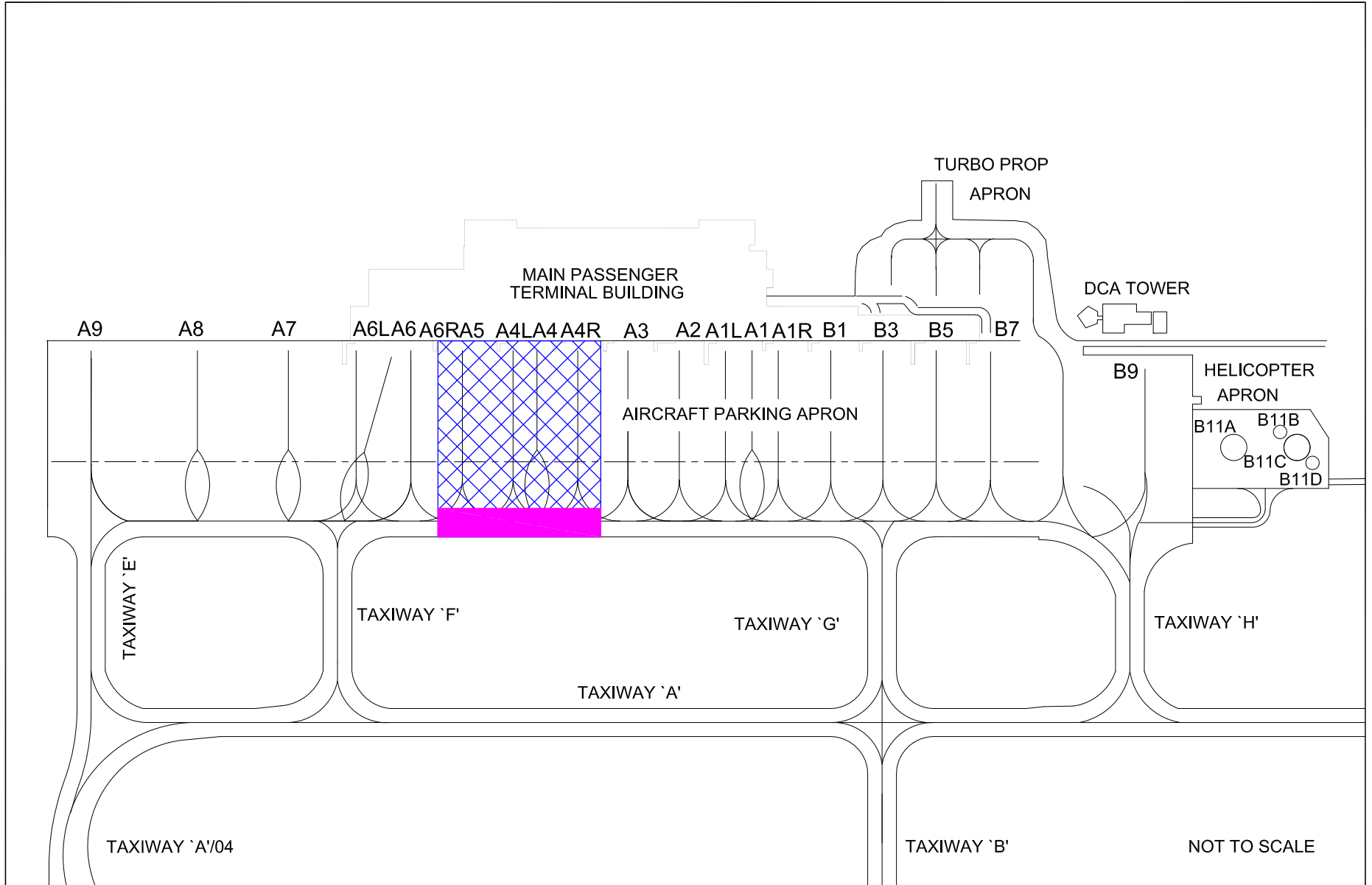

PENANG INTERNATIONAL AIRPORT PAVEMENT REHABILITATION TEMPORARY RE-ALIGNMENT OF APRON TAXIWAY PHASE 5 : DURATION 55 DAYS

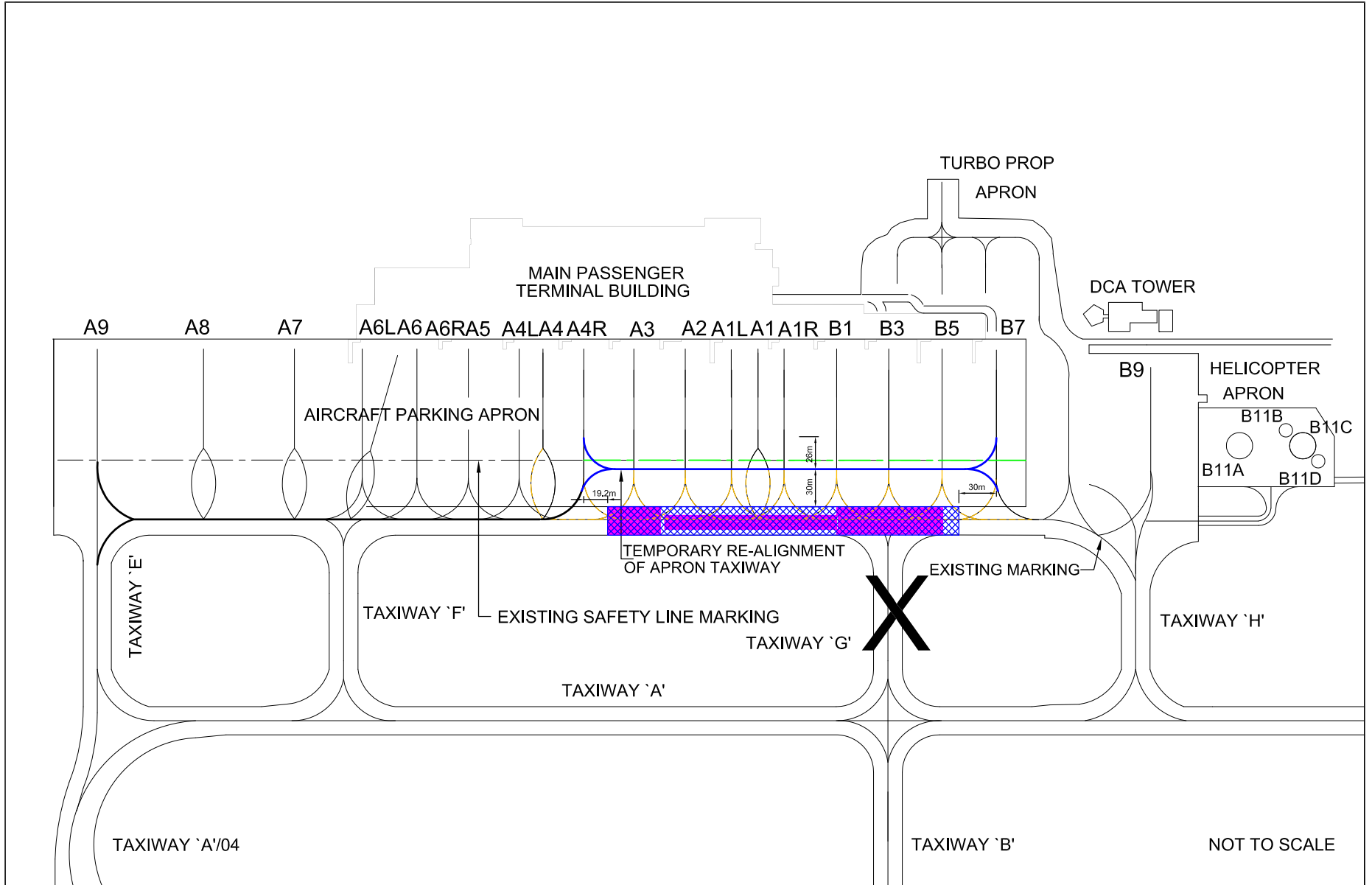

PENANG INTERNATIONAL AIRPORT PAVEMENT REHABILITATION RUNWAY PHASE 6 : DURATION 79 DAYS

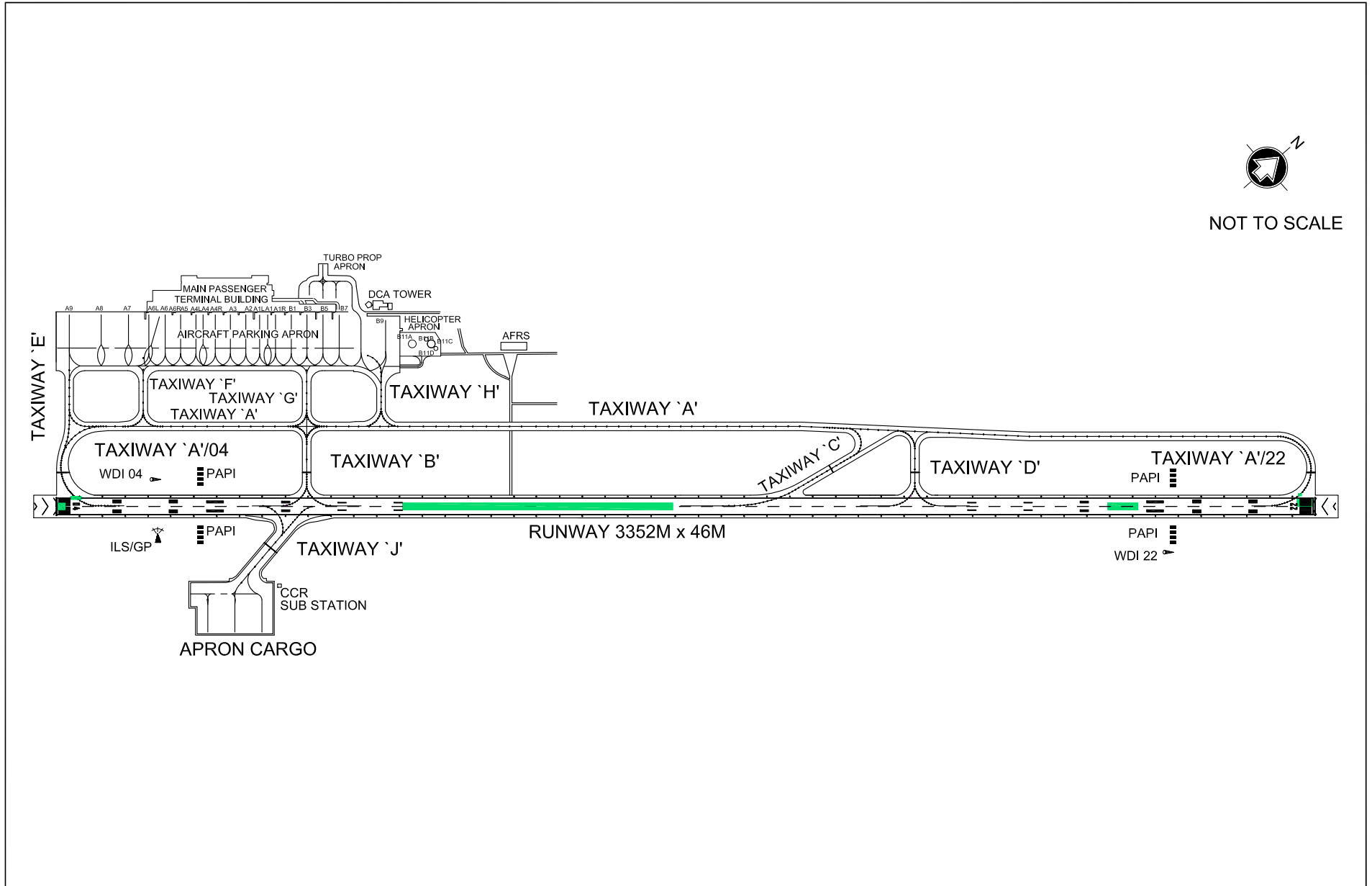

PENANG INTERNATIONAL AIRPORT PAVEMENT REHABILITATION TAXIWAY A/4 PHASE 7 : DURATION 19 DAYS

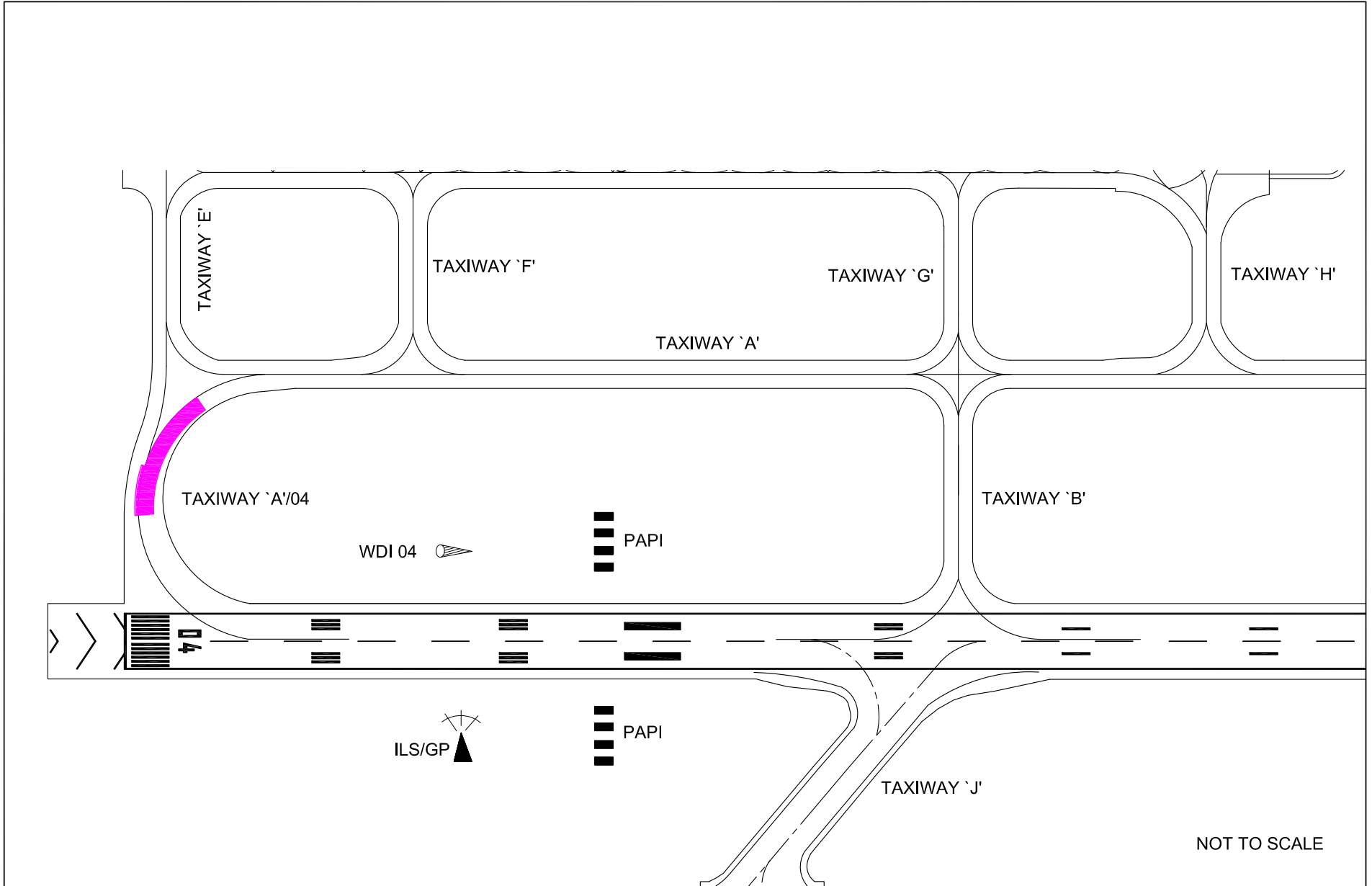

PENANG INTERNATIONAL AIRPORT PAVEMENT REHABILITATION TAXIWAY A/22 PHASE 8 : DURATION 60 DAYS

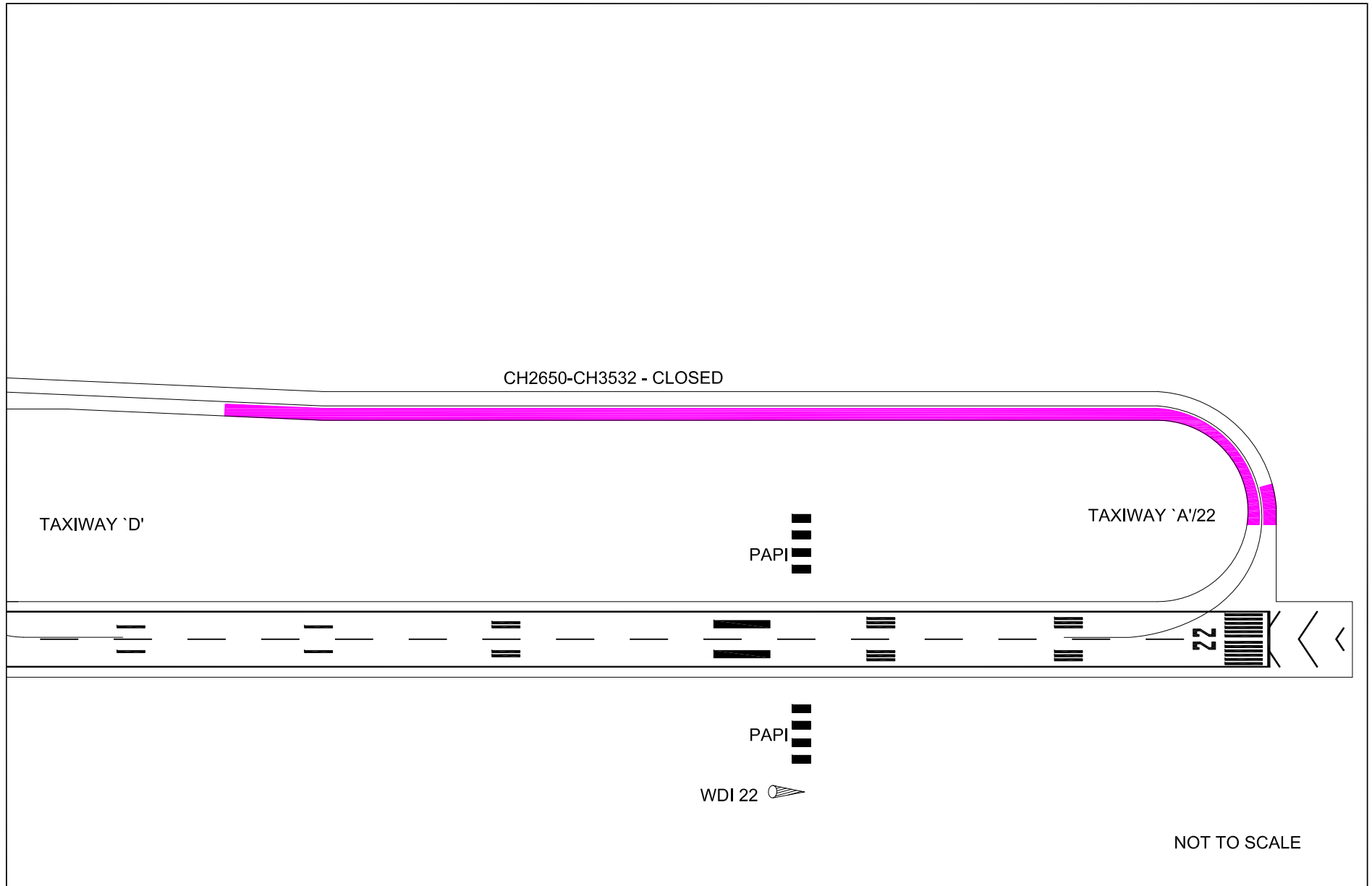

PENANG INTERNATIONAL AIRPORT PAVEMENT REHABILITATION TAXIWAY A/C INTERSECTION
PHASE 9 : 20 DURATION DAYS

